

PARTS AND ACCESSORIES

KAYAKING + FISHING
MARCH 2015



Hobie



TABLE OF CONTENTS



ITEM	PAGE
LIFE VESTS / PFD	2-3
SAFETY / WATER WEAR / GLOVES	4-5
MIRAGEDRIVE® ACCESSORIES	6-7
SAIL KITS	8-9
SIDEKICK / DODGER / TRAMPOLINES	10-11
HOBIE SAILCLOTH BAGS	12-13
<hr/>	
KAYAK CARTS / BEACH DOLLIES	14-15
TRAILERS / RACK PADS / STRAPS	16
RHINO RACK LOAD ACCESSORIES	17
COVERS / RIGGING STANDS	18-19
HATCH LINERS / GEAR BUCKETS	20
HATCHES / DRY BAGS / TACKLE BOXES	21
<hr/>	
eVOLVE MOTOR	22
LIVWELL	23
H-BAR / H-RAIL MOUNTS - ACCESSORIES	24-25
HOBIE - SCOTTY ROD HOLDERS / MOUNTS	26-27
RAM ROD HOLDERS / MOUNTS	28-29
ACCESSORY MOUNTS	30
POWER POLE	31
STAKE OUT POLE / DRIFT CHUTE / ANCHOR KIT	32
ROD LEASH / ANCHOR TROLLEY	33
ELECTRONICS PACKAGES / MOUNTS	32-33
FISHFINDERS / GPS / MOUNTS	34-35
<hr/>	
HARDWARE / LINE / MAINTENANCE	36-37
MISC ACCESSORIES / TOOLS	38
SUNGLASSES / STICKERS / MEDIA	39
SHIRTS / HATS	40
HOBIE SPORTSWEAR	41
<hr/>	
KAYAK SUPPORT	43
KAYAK FAQ	43
PARTS WARRANTY INFO	43
LIVWELL PARTS	43
PARTS DIAGRAMS	44-59
NUMERICAL PARTS LIST	60-65

Note: Freight to dealers is not included in pricing.

No portion of this catalog may be reproduced without the express permission of the Hobie Cat Company.

All rights reserved. ©2014 Hobie Cat Company, Oceanside, CA 92056
Printed in USA



BACK FLOTATION
ABOVE SEAT BACK

HOBIE HI-BACK MESH by Stohlquist

This front entry vest was designed just for Hobie Kayaks! The flotation in the back is up high and away from the seatback (less bulk down low). Short length does not "ride up" around your neck when you are sitting. There is a mesh panel across the back. Front zip entry for easy on and off. A zipper keeper to prevent the zipper from slipping down when in use. Large mesh pockets on the front for easy storage and access of small items. Stretchy neoprene adjustable padded shoulders. Ventilated mesh side panels. High waistline cut. Huge arm cutouts and a short waist allow excellent freedom of movement. Adjustable side straps offer enough size variation for many layers underneath or none!

S6143xxx MANGO (xxx = SMD / LXL / XXL)
(UL - Approved) for use in USA Only

S6145xxx ULC - MANGO (xxx = SMD / LXL)
(ULC - Approved) for use in Canada Only

S6143-4-5 Sizes (Chest): SMD 30" - 42"
LXL 42" - 52" / UNIVERSAL 30" - 54"



S6146/47 Sizes (Chest):
XSS 30" - 36"
MLG 36" - 42"
PS 40" - 46"

WOMEN'S HOBIE HI-BACK by Stohlquist

Many of the same features as the Hi-Back Mesh, but shaped and contoured specifically to fit women. Foam layering inside the vest is contoured for a better fit. (xx= XSS / MLG / PS)

S6146xx POWDER BLUE (xx = size)

S6147xx MANGO (xx = size)



HOBIE HI-BACK FISHERMAN by Stohlquist

Ready and loaded, this new fishing and hunting vest is the ideal PFD for the sit-on-top kayaker, providing comfort and water safety with all the necessities, close at hand. Put to work, while you play, the FISHERMAN provides excellent cockpit management with places for the little things like pliers and extra tackle. The EVA front pockets fold down to provide a work station and are sized to fit small tackle boxes. The FISHERMAN'S outer platform provides mounting locations for tippets, retractors, nippers, leader-line, hemastats, and pliers. Choose between low-vis Cactus color or hi-vis Mango with 3M reflective strip. Safety, comfort, storage and utility make this the ultimate vest for fishing or hunting.

The Drawbridge...dual front-mounted tool pouch pockets have protective EVA stiffened outer shells to protect pocket contents when re-boarding the kayak from "over the rim".

- EVA inner platform - is a fold-down work surface.
- Velour (hook & loop style) -inner lining attachment surface.
- Sized to fit small plastic lure boxes.
- Inside accessory pockets and stowage for tools.

Outer Platform....like an angling vest, the FISHERMAN vest has mounting locations for tippets, retractor(s), nippers, leader-line, hemastats, and pliers.

FEATURES: Choose low-vis Cactus color or hi-vis Mango with 3M reflective, Open sides for ventilation, Neoprene padded shoulders and lower back waistband, 1-1/2" webbing belt with dual side adjustments, Multiple pockets, all with drainage, High-back flotation rides above back rest, Adjustable 1-1/2" webbing shoulder and side adjustments, Cinch harness adjustment for zero ride-up, New PVC-free Gaia foam.

SMD / LXL / XXL (Cactus / Mango)

S6149xxx HI BACK FISHERMAN CACTUS (xxx = size)

S6148xxx HI BACK FISHERMAN MANGO (xxx = size)

(UL - Approved) for use in USA Only





HOBIE MIRAGE PFD

This PFD was designed specifically for Vantage high back seats on Hobie Mirage Kayaks. The flotation in the back is thin for more comfort while seated and helps to prevent the vest from riding up as you pedal. A vent along the spine adds to the comfort. Front zip entry for easy on and off. Large pockets on the front for easy storage and access of small items. High waistline cut so the vest does not ride-up while pedaling. Huge arm cutouts and the short waist allow excellent freedom of movement. Adjustable side straps offer enough size variation for many layers underneath or none! Reflective tapes for visibility during low light conditions. Back logos vary between "H" and Penguin Logo.

S6880xxX HOBIE MIRAGE PFD GRAY/BLACK (xxx = SM/MD - MD/LG - LG/XL)
(UL - Approved) for use in USA Only

- S6800SMD** PFD MIRAGE GRAY - SMALL/MED
- S6800MLG** PFD MIRAGE GRAY - MED/LARGE
- S6800LXL** PFD MIRAGE GRAY - LARGE/XLG



NOTE: AIR SHIPPING RESTRICTIONS CO2 / DANGEROUS GOODS

HOBIE INFLATABLE PFD

Light weight and comfortable. Ready when you need it, manual CO2 inflation or buy mouth inflator allows for swimming, wading and intentional immersion.

Available in Mango, Tan/Gray or Red/Gray.

- S6779MG** MANGO
- S6779TG** TAN / GRAY
- S6779RG** RED / GRAY

S6779R PFD INFLATABLE REARM KIT

- Buoyancy: 26 Pounds
- Inflator Type: Halkey Roberts 3F
- Primary Inflation: MANUAL
- Auxiliary Inflation: Oral
- Size and U.S.C.G. Wearer Requirements
- Adult Universal: For persons 16 years or older, weighing more than 80 lbs., with chest size of 30 - 52 inches

- U.S.C.G. Approval Type: U.S.C.G. Type III
- Durable Ripstop Nylon Front Shell
- Waist Belt Width: 1"
- Zippered External Pocket
- Safety Whistle
- Reflective Strips
- Sunglass Hanging Loop

HOBIE SHORT-PROFILE VEST

by Stohlquist
This side entry design has set the standard for streamlined pfd fit. Cool mesh side panels and reflective accents. Stretchy neoprene adjustable padded shoulders. Roomy mesh pocket with "D" ring for keys. Ventilated mesh side panels. High waistline cut. Huge arm cutouts and a short waist allow excellent freedom of movement.

Extra short length does not "ride up" around your neck when you are sitting. Adjustable side straps offer enough size variation for many layers underneath or none!

SM / MD / XL / XXL

(UL - Approved) for use in USA Only

S6142xx (xx = size)



S6142 Sizes (Chest): SM 32" - 36" / MD 36" - 40" / XL 44" - 48" / XXL 48" - 52"



HOBIE INFANT/CHILD/YOUTH VESTS

Our children's life vests meet the same functional requirements as those for adults. We've selected the, easier to put on, clip model. These are easy to adjust for different small sized crews. (Mango)

- S6770IMG** <30 lbs
- S6770CMG** 30 to 50 lbs
- S6770YMG** 50 to 90 lbs



HOBIE INFLATABLE BELT PACK PFD

Extremely lightweight and comfortable belt carried PFD design is cooler and more comfortable than typical PFDs. Functional design for multiple types of water sports from fishing, kayaking, sailing to stand up paddling (SUP). Belt pack style stays out of the way till you inflate and put the bladder on over your neck. Adjustable waist. Buoyancy: 26 Pounds. USCG Approved Type III PFD, approved for use by persons 80 lbs and 16 years of age or older. Size: Universal Adult Size. Durable ripstop nylon pack. 2" wide, adjustable, nylon waist belt. Includes (1) CO2 Cylinder and instructions.

S6780RG RED/GRAY

SAFETY TIP

LIFE VESTS: Get a good, comfortable life vest and WEAR IT! A life vest does you little good stored on your boat, especially if you get tossed into the water and away from your boat. Accidents happen and by their nature, they happen when you are not prepared. A life vest can keep you afloat until you can rescue yourself or you can be rescued by others. In the worst cases when injuries or cold water are involved, your life vest can make all the difference! Be sure everyone onboard your boat wears a life vest too! Pass the word! Federal law now requires that all persons below the age of 13 must wear a life jacket while aboard a boat.

THE VISICARBON PRO™

The Visicarbon Pro combines a high visibility light and safety flag with a light weight, low drag, and portable style. Insert foam base into molded-in or Live Well rod holders. Features: The ultra thin mast and redesigned flag combine to offer excellent performance with low wind drag. Main mast section designed with carbon fiber tubing for high strength and ultra light weight. The VISICarbon Pro™ weighs in at just 14 ounces, complete with 3 AA batteries. The 48" long VISICarbon Pro™ breaks down to 14" long in seconds. Place into a molded-in rod holder tube or Flag attachment system provides a secure attachment that allows the flag to be removed in seconds. The folded unit can be stored inside the nylon flag which doubles as carry bag. **72020040 SAFETY FLAG/LIGHT COMBO**

(Suggested Mount 72020051 MightyMount See more Yakattack mount options)



SAFETY FLAG

Be Seen! When out on your kayak, you are very low to the water. Add to that any wave or swell action and you are often hidden from other boaters view. The 4' tall safety flag will help other boaters see you. Very important in areas with mixed boating traffic! For mounting in areas with internal access, you can use large washers and the provided nuts for mounting. Otherwise, in areas with no internal access, use the mount which includes bolts and well nuts.

72020002 SAFETY FLAG 4'
72020012 DELUXE MOUNT

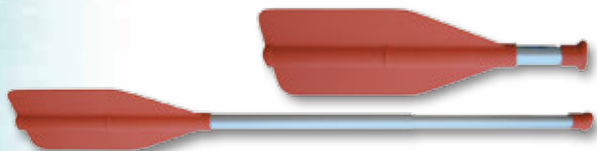

TELESCOPING PADDLE

This is a good spare paddle that can be stored within most Hobie kayak models. 6 1/2" wide blade will fit into an 8" hatch opening. Measures just 20" in closed position (45" when fully extended). Lightweight, easily portable yet with durable construction of high grade plastic paddle and anodized aluminum shaft. Corrosion resistant design. Floats too! **3091 TELESCOPING PADDLE**



SAFETY WHISTLE

A must while on the water! You simply cannot beat the attention grabbing shrill of a whistle. A whistle can save your life! Keep one attached to your PFD in case of overboard emergency. Alert approaching vessels. Alert other boaters or people ashore that you need help. **MK0053 SAFETY WHISTLE**



HOBIE SAFETY KIT

This kit has many useful items for added safety when boating. Includes first aid and some basic survival materials. Hobie Gear Bucket with Orange safety lid. Ready access is assured by hanging the safety kit on the inside lip of an 8" Hobie Twist and Seal hatch. Includes a 33 piece first aid kit, water proof flash light, signal mirror, space blanket, whistle, utility tool, waterproof matches, duct tape, gauze bandage, gauze pads, cloth tape (specific items subject to change). **72020010 HOBIE SAFETY KIT**



BILGE - HAND PUMP

Water over the bow while you have a hatch open can leave you with a flooded hull. This light weight pump is security for long trips on the water. Features super-comfortable, easy-grip rubber over-molded handle and a high-visibility neon yellow stock for extra safety. **72020032 BILGE - HAND PUMP**

HYDROSTAR – S.O.S DELUXE "HOBIE"

Whether you're paddling, sailing, camping, fishing, hunting or just changing your tire the Hydrostar offers an unmatched combination of features that makes it a must-have for all your water sports, outdoor and travel needs. Everything you need for lighting in one compact waterproof package.

HYDRO STAR FEATURES:	
2-way LED FLASHLIGHT	Suction cup base
Emergency XEON STROBE	Strong magnetic base
Programmed S-O-S SIGNAL	Twist action control switch
Waterproof up to 50 feet	Safety leash
	Batteries included

72020003 HYDRO STAR SOS LIGHT



SAFETY PACKAGES



72020029 DELUXE KAYAK SAFETY PACKAGE

- 1 **72020010** Hobie Safety Kit
- 1 **72020040** Visicarbon Safety Flag / Light
- 1 **72020032** Bilge Pump



72020026 KAYAK SAFETY PACKAGE

- 1 **72020010** Hobie Safety Kit
- 1 **72020002** Safety Flag
- 1 **72020003** Hydrostar Light

HOBIE WATER WEAR

Be more comfortable and extend your kayaking / sailing season by dressing appropriately for the conditions. Hobie water wear is designed for both kayaking and sailing needs.

HOBIE LYCRA

Designed for active kayaking and sailing. Quickdry performance fabric with UV protection.



HRG02010A

HRG020TNV

HOBIE LYCRA LONG SLEEVE

HRG02010A / HRG020TNV (S,M,L,XL,XXL)



HRG05010A

HRG050TNV

HOBIE LYCRA SHORT SLEEVE

HRG05010A / HRG050TNV (S,M,L,XL,XXL)



HRG03000C

HRG03010A

H LYCRA SHORT SLEEVE RASH

HRG0300C / HRG03010A (S,M,L,XL,XXL)



HRG04000C

HRG04000A

H LYCRA LONG SLEEVE RASH

HRG04000C / HRG04000A (S,M,L,XL,XXL)



HOBIE SPRAY TOP

Designed for active kayaking and sailing. Can be worn with swim trunks or over a wetsuit. Mix and match layers to get the comfort you desire. Spray and wind protection. Beautiful styling and extra durable construction. Construction Features: Neck and wrist seals, Neoprene waist seal, Breathable 5000cm3 nylon shell, Offset chest pocket, Arm patch pocket. Colors vary.

HOBIE SPRAY TOP

3850SM / 3850MD / 3850LG / 3850XL



HOBIE SPORT TEE

Designed for active kayaking and sailing. Quickdry performance fabric with UV protection. Quickdry 100% polyester mesh (Polyester yarn with wicking dry and anti-bacteria function) UPF50+ Mix and match layers to get the comfort you desire. Men's available in long or short sleeve. Women's version has a V-Neck.

HOBIE SPORT TEE MEN'S LONG SLEEVE

3857SM / 3857MD / 3857LG / 3857XL

HOBIE SPORT TEE MEN'S SHORT SLEEVE

3858SM / 3858LG / 3858XL

HOBIE SPORT TEE WOMEN'S SHORT SLEEVE V-NECK

3859SM / 3859MD / 3859LG



PEDAL PAD KIT

Softer on your feet! Neoprene pads are self adhesive and stick right to your pedals. Stock on Drives built in 2010+
72020034 PEDAL PAD KIT BLACK (PAIR)



DRIVE WELL SEAL

Keeps the seat area drier. Seals the aft end of the MirageDrive well. Limits the incursion of water into the cockpit caused by the surge action of the drive fins. Testers also claim some improvement of forward thrust. Easily attaches to older MirageDrive spines (pre-2013). Kit includes one seal and two attachment "zip ties".
81037001 WELL SEAL
81038001 i - WELL SEAL



Hobie MirageDrive GT shown

HOBIE MIRAGE SPEEDO

Removable, "pitot tube" speedometer measures your pedaling speed. Fits MirageDrive systems with plastic spine on drive serial number 16054 - Winter 2013 production. Latest version spines are not compatible.
80030001 SPEEDO



HOBIE MIRAGEDRIVE "GLIDE TECHNOLOGY"

- 80010501** MIRAGE DRIVE GT - ST FINS
- 80013501** MIRAGE DRIVE GTi - ST FINS iSERIES
- 80012501** MIRAGE DRIVE GTT - ST TURBO FINS



LEASH KIT - MIRAGEDRIVE

If you ever remove your MirageDrive while on the water... protect your investment from an accidental drop overboard. Includes hardware for attachment to the hull.
74052101 LEASH KIT - MIRAGEDRIVE

MIRAGEDRIVE STOW BAG

Protect your MirageDrive... and other goods in your car from the drive! This heavy duty Cordura and mesh bag fits the complete MirageDrive with standard fins or the ST Turbo length. It has small pockets inside for the speedo tube, scupper plugs or spare parts. Has a carry handle and a shoulder carry strap. There is extra space in the bag for things like a life vest or drive well plug. Also includes "D" ring fittings to allow attachment to Inflatable rolling bags. Large enough to store your Inflatable's drive, pump and 4 piece paddle.
80024 MIRAGEDRIVE BAG



Now you can make your Hobie MirageDrive a SUPER PERFORMER!

PERFORMANCE FINS - ST OR ST TURBO!

The Hobie MirageDrive is the most amazing propulsion system ever seen! But there is more!

Increase your performance or increase your fitness routine, you choose the fin that is right for you: Standard, ST or ST Turbo... low, medium or a higher gear! The standard fins, supplied with our kayaks, are the easiest pedaling fins, but some users feel that the standard fins do not offer enough resistance. This is very evident when using a sailing kit. The added power and speed of the sail often outpaces the standard fins (similar to pedaling a bike down hill in first gear).

Want to go really fast? Add ST TURBOs. Hobie Mirage kayak users report as much as 10% increase in speed and more using ST TURBO Fins. But its not all about speed, you can get top end speed and a slower cadence for cruising (Less pedals per mile). All achieved with these larger and more efficient fin designs. These longer fins can also increase lateral resistance for sailing upwind.

The ST (Square Tip) designs will require a bit more effort to pedal. The added effort is commonly compared to pedaling a bike up a slight incline. In addition, the included fin tension screw allows adjustment to achieve lower end torque or top end speed to meet the desires of the pedaler.

ST TURBO FINS & KITS

Kits come with 2 fins & 2 longer masts (available for V1 or V2 drives)

- 72066001 ST TURBO FIN KIT V2/GT - GRY/BLK (Threaded Sprocket)
- 72066021 ST TURBO FIN KIT V2/GT - RED/BLK (Threaded Sprocket)
- 72066031 ST TURBO FIN KIT V2/GT - BLU/BLK (Threaded Sprocket)
- 72065 ST TURBO FIN KIT (Older SS & Set-screw Sprocket)

- 81192001 ST TURBO FIN - GRY/BLK Single (replacement)
- 81192021 ST TURBO FIN - RED/BLK Single (replacement)
- 81192031 ST TURBO FIN - BLU/BLK Single (replacement)

ST FINS fit any Standard Hobie MirageDrive

- 81193001 ST FIN / SINGLE - GRY/BLK Single (replacement)
- 81193021 ST FIN / SINGLE - RED/BLK Single (replacement)
- 81193031 ST FIN / SINGLE - BLU/BLK Single (replacement)



MIRAGEDRIVE SPARE PARTS KITS

Spare parts kits include a fin, mast, sprocket, chain and appropriate parts for the drive version. Older drives have sprockets and masts that use a set screw connection. V2 drives use threaded sprockets and masts. All in a handy zippered pouch. Don't waste a day on the water when your MirageDrive could be easily repaired. Available for the standard fin drive or a drive with the ST Turbo fins. Standard kit shown.

- 80010301 V2 STANDARD (Threaded Sprocket)
- 80010401 GT ST (Threaded/Bearing Sprocket)
- 80013301 V2 TURBO (Threaded Sprocket)
- 80013401 GT TURBO (Threaded/Bearing Sprocket)





HOBIE KAYAK SAIL

ADD SAILING TO YOUR HOBIE MIRAGE KAYAK EXPERIENCE!

MIRAGE KAYAK SAIL RIG

Add sail power to Hobie Mirage Kayaks! (Fits all current models of Hobie Mirage Kayaks). Paddle kayaks do not have the necessary lateral resistance needed nor do they typically have a rudder for steering. Paddle kayaks require hands-on paddling which prohibits use of rudder and sail controls for sailing. Hobie Mirage kayaks are equipped with a hand-controlled rudder. The MirageDrive allows hands to be free for sail and rudder controls. The Patented MirageDrive pedal system allows you to pedal while sailing which also helps you to maintain forward motion through turns and obtain higher speeds. Sail with ease maintaining excellent speed with or without pedaling while sailing. Easily pedal out to sail or pedal home when the wind is too light. Add a SideKick ama kit for additional stability if desired. The MirageDrive pedal system's fins act as a keel or centerboard when in the down position offering the lateral resistance needed for upwind sailing. **SAIL KIT includes mast*, sail (20.25 sq ft.), lines, fittings and storage bag. (*2 Piece mast standard / 4 Piece mast for i-Series)**

Add the large rudder #81397001 for more responsive rudder control. Adventure models can add the dagger board for enhanced upwind performance.



i-Series 79052203
84515001

i-Series 79052204
84516001

84514001

i-Series 79052202
84513001

- 84513001 SAIL KIT (Turq/Papaya)
- 84514001 SAIL KIT (White/Red)
- 84515001 SAIL KIT (White/Turq)
- 84516001 SAIL KIT (Silver/White)

- 79052202 i-SERIES SAIL KIT (Turq/Papaya)
- 79052203 i-SERIES SAIL KIT (White/Turq)
- 79052204 i-SERIES SAIL KIT (Silver/White)



ROLLER FURLING KIT

This is the ultimate for easy operation of a Hobie Mirage sail kit. Start with the sail rolled around the mast. When you are ready... un-furl to expose the sail or leave a little rolled on the mast to test the wind! By partially unrolling the sail, you are "reefing" some of the sail for better control and stability. If you are ready for full power... roll it all out! Such a great addition to our VERY popular sail accessory. Fits any previously sold Hobie Mirage sail kit (not for i-Series kayaks due to their stayed rig). Heading back to the beach? Roll the sail up tight on the mast and beach or dock the kayak with ease. The rolled sail will fit in current full-length sail bags. Hardware is easy to install and removal of the sail and control lines is simple for storage.

- 84517001 ROLLER FURLING KIT



Sailing with Dodger



Sailing with SideKick Ama Kit

See following pages for Dodger and SideKick!

Large Twist and Stow "Sailing" Rudders

Adventure Daggerboard



81397001

81397101
for use on
i-Series, Quest



For top sailing performance, add the ST TURBO fin kit and larger rudder!

- 81397001 "SAILING" RUDDER BLADE (Lg TnS)
- 79502001 ADVENTURE SAILING DAGGERBOARD
- 84503 REPLACEMENT 2-PIECE MAST
- 79052251 REPLACE 4-PIECE (i-SERIES) MAST
- 84511 REPLACEMENT SAIL BATTEN W/CAP
- 84509001 REPLACEMENT BATTEN CAP
- RH112WHT BATTEN TIE LINE (PER FOOT)

AIR-FLOW TELS

Trim your sails for optimum performance. Attached air flow over sails is critical. Air flow directions are indicated by these tell tails. Made of light weight rip stop nylon (Red / Green). Attaches to sails with waterproof adhesive disks.

334 SET OF 14



RONSTAN GLOVES

'Amara' synthetic leather for maximum durability, minimum stretch and shrinkage. Double Aramid stitching in high wear areas. Double thickness palm and fingers for protection and grip. UPF 50 (Ultra-Violet Protection Factor). Mesh panels for flexibility, comfort and quick drying. Low cut neoprene wrist band for secure fit and clear access to start watch. Sticky gloves reduce fatigue by minimizing the physical effort required to hold rope. (xx = size XS/SM/MD/LG/XL)



RF4851xx THREE FINGER GLOVE

RF4850xx SHORT FINGER GLOVE



HOBIE GLOVES

Protect your hands while increasing your grip strength. Gloves add grip strength on lines which can ease up on the amount of force you need to exert. Available in small, medium, large & extra-large. (xx = size)

3188xx HOBIE GLOVE



The Hobie Island Club is a place to meet other Hobie Mirage® Adventure Island and Hobie Mirage Tandem Island owners to share passions for the waterways and oceans of our world. Hobie Dealers are organizing local Island Clubs worldwide. The Hobie Island Club will assist in the introduction of Island owners to one another where dreams of sailing to places unknown and countless adventures can become a reality. hobiecat.com/hobie-island-club



💡 SAILING TIP!

SAIL POWER Watch the sail, pay close attention to the trim or adjustment of the sail. When the front of the sail, just behind the mast, luffs or flutters in the breeze, you lose power. To start moving, pull the sail in just enough to stop the sail from luffing or turn the boat away from the direction the wind is coming from. There are also short ribbons hanging on either side of the sail called "tell tails". The tell tails react to air flowing over the sail and will help you see that the sail is pulled in too tight or too loosely. If you pull the sail too tight you will stall the sail power. The tell tail on the back side of the sail will drop or do circles. Ease the sail out until it luffs, then pull it in just a little until it stops luffing. You will adjust the trim whenever the wind changes direction or you change course.

SIDEKICK AMA KIT

Whether you are a pro or a novice, you will enjoy the stability of the SideKick ama kit. Great for use when sailing, fishing, standing when site fishing, diving or shooting photos! SideKick ama kit is simple, light weight and effective! Floats are inflatable.

The SideKick's cross arms adjust the float height with a simple "click-twist-click". Just like a paddle shaft adjustment. Three positions offer you high - medium - low positions. Set the floats high for cruising (less drag) or secondary stability. Use the medium or low settings for primary stability (less initial roll). Fine adjustments for float height are done by twisting the main crossbar within its mounts and tensioning with the fastening hardware.

Set up and use right off the beach or disassemble and deflate to store inside the hull. Then assemble and inflate when you get to your dive or fishing spot. Inflation is simple. Just blow a few breaths into each float through their one-way valves. Valve cap unscrews for rapid deflation. Installs with 4 bolts using expanding nuts. Not for use on Pro Angler models.

72062101 SIDEKICK AMA COMPLETE KIT - Light Gray

72063101 SIDEKICK AMA COMPLETE KIT - Dark Green

72062061 SIDEKICK +07 ADVENTURE MOUNTING ADAP PLATE SET
(Adapts Island crossbar attachment point to SideKick mount spacing)

72062062 SIDEKICK - MOUNT KIT W/CENTER BAR
(For second hull installation. Crossbar and mount hardware only)



MIRAGE SEAT PAD – INFLATABLE “I-COMFORT”

Adjustable comfort! Replaces the standard foam seat pad for the Hobie Mirage. Adjust the cushion by adding or releasing air pressure. Like an inflatable camping pad. Has an internal self inflating foam and an air valve through which the pad can be further inflated / deflated to suit the users comfort. Not designed for use on Hobie Mirage Inflatable kayaks. Can be used in combination (stacked) on the standard seat cushion.
72020028 MIRAGE SEAT PAD – INFLATABLE “i-Comfort”



GUSSETED STOW BAG

6" by 12" gusseted tramp bag has hooks on both ends to clip to your boat. Also available in 8" x 12" size. Securely stow tools, gloves or small parts for easy access on board your kayak.
72000B 6"x12" GUSSETED TRAMP BAG
72005B 8"x12" GUSSETED TRAMP BAG

STEERING KNOB ASSY

Get a grip on your steering. More comfortable hand position - better leverage. Knob only, fits all 2011+ Mirage model steering handles and all Tandem Islands.
88991355 KNOB ASSY

Includes knob, attachment bolt and cap



HIKING STICK

Extend your reach to your steering. Designed for use on Hobie Islands. Allows you to move your weight (hiking) outboard for better stability, speed and comfort. Fits 2011+ Mirage model steering handles and all Tandem Islands.
72020063 HIKING STICK - AI/TI



PADDLE “T” HANDLE

Convert your kayak paddle to a canoe style paddle. Easier to store on many models of Hobie Mirage kayaks where paddle use is unnecessary while using the MirageDrive. Plugs into the female half of the kayak paddle.
74049001 PADDLE “T” HANDLE

HOBIE DODGER

The Hobie Dodger is a spray, cool breeze or sun shade for your lower body. Deflect bow spray, block cool breezes and stay warmer in cold conditions.

Works like a small pop-up tent. Loops of bungee connect to the boat via small fittings installed along the rails. Small internal battens give the Dodger its shape. The Dodger extends aft to just in front of the pedaler. A Velcro strip seals up the center in front of the pedaler. The entire dodger folds forward to enter or exit the kayak, to make pedal adjustments or reach items in the cockpit. An access panel is built-in for using the sailing rig. A great combination when there is wind and spray!

Great for hunters, animal and bird watchers as the Dodger conceals your legs movement. The Hobie Dodger makes your kayak a sit-inside sit-on-top!

Installs in minutes initially, but installs in moments once the fasteners are in place. Packs away into a small stow bag.

Fits the Hobie Mirage Pro Angler.



PRO ANGLER CAMO

HOBIE PRO ANGLER DODGER
72730003 PRO ANGLER DODGER CAMO

ISLAND TRAMPOLINES



HOBIE MIRAGE ADVENTURE ISLAND AND TANDEM ISLAND TRAMPOLINES

Aka Trampolines do many things... Added space for carrying gear, allows you to move weight outboard for better performance in windy conditions, comfortable sitting or laying down position, carry additional crew / kids / pets (does not increase basic weight capacity), reduce spray in cockpit. The trampolines are made from mesh vinyl as used on our catamaran product. Available in Gray or Black. Easy installation. Fast (side-release) buckles across aft aka make folding akas quick. Adjustable webbing straps for a tight fit. Rolls down and straps to forward aka for storage or easily slips off the aka. Paddle storage, gear pockets and lanyard grommets included. (200 Lb Capacity)

- 79527001 TRAMP SET AI – BLACK
- 79527011 TRAMP SET AI – GRAY
- 88527001 TRAMP SET TI – BLACK
- 88527011 TRAMP SET TI – GRAY

REPLACEMENT PARTS

- 79527101 LACING ROD
- 79527201 WEB/BUCKLE ASSY

A romantic couple is shown on a sailboat. The woman is seated on the deck, wearing a white halter-neck top and shorts, looking towards the man. The man stands behind her, wearing a white button-down shirt and sunglasses, leaning in. A white drawstring bag with a black bird logo and a colorful patterned band hangs from the deck. The background shows a beach with a seagull and the ocean under a bright sky. A yellow hexagonal graphic with arrows is overlaid on the top left.

**RECYCLED
SAILCLOTH
BAGS**

HANDCRAFTED IN THE USA

Hobie

RECYCLED
SAILCLOTH
BAGS
HANDCRAFTED IN THE USA



72026002 SAILOR SLING BAG
18" wide x 17" high x 10" deep

72026001 BEACH TOTE
20" wide x 16" high x 12" deep



72026003 WINE BAG
8" wide x 14" high x 4.5" deep



72026004 MULTI-PURPOSE ROLL BAG
12" wide x 14" high x 5" deep



72026000 DUFFLE BAG
22" wide x 12" high x 12" deep

KAYAK CARTS

Kayak Carts or Dollies are a must for easily transporting your kayak from car to water's edge. Simply roll the kayak down to the water and off you go! All of the latest Hobie Kayaks can use "Plug-in" carts. "Plug-in" carts do just that...they plug right into the bottom of your kayak. Choose Standard for light duty and solid surfaces, Heavy Duty for heavy loads and rough terrain or the "all-terrain" Hobie Trax "2" version which is the best over soft sand. Each cart has a sturdy stainless steel frame. Some older models or other brands of kayaks may require the use of a cart that straps on.



KAYAK CART "PLUG-IN" STANDARD

Light weight with durable 26 cm tires and strong spoked wheels. Stainless steel frame. Wheels are easily removable for storage. Also includes cart keeper feature and cart clamps. This cart has the medium capacity. (150 lb Capacity). Great for transport over solid surfaces.

80045001 STANDARD CART

80045101 i - KAYAK CART

i - kayak cart (not pictured) plugs into an inflatable's MirageDrive well.



KAYAK CART - "PLUG-IN" HEAVY DUTY

Highest capacity cart with very durable knobby (Solid Foam) 26 cm wheels. Welded Stainless steel frame. Wheels are easily removable for storage. Also includes cart keeper feature and cart clamps. This cart has the highest capacity. (225 lb Capacity) Suitable for Pro Angler and Tandem Island. Best for transport over solid surfaces.

80046001 HEAVY DUTY CART

**Note Tandem Island use issue*

80046021 PIN, QUICK CLIP

Wheel retainer pin for Std and HD carts.



KAYAK CART "PLUG-IN" HOBIE TRAX "2"

The Trax "2" Cart has 24 cm (blow-molded polyurethane) pneumatic tires. These tires have a high capacity and are very durable! Welded Stainless steel frame. Wheels are easily removable for storage. (176 lb Capacity) This is an all around cart for soft sand and uneven terrain. The tires are wide and can be deflated for better performance over softer sand and soil.

80044101 TRAX "2" CART

**Note Tandem Island use issue*

CAUTIONS: Be certain that the cart inserts clear through the kayak and protrudes into the cockpit / cargo area surface. Kayaks should never be left on carts for prolonged periods of time.



CART KEEPER FEATURE

Standard on Hobie Plug-in carts! After insertion of the cart, pull the dome pin out and re-insert as shown to keep the cart captive.

POST COLLAR / CLAMP FEATURE

Collar clamps help to reduce the direct loading of the cart on your kayak's bottom / keel. Direct loads on hull bottoms can cause deformation of the kayak. Even loading at scuppers and hull bottom reduces hull-bottom deformation issues. Included with all new plug-in carts.



KAYAK CART - UNIVERSAL

This cart attaches to any kayak via straps and buckles. Pneumatic wheels allow this cart to roll more easily over rough terrain. Padded "hull-centering" bunks keep the kayak centered on the cart while the tie down straps hold the cart firmly to the boat. Carries loads up to 150 lbs. Welded Stainless steel construction. Wheels are easily removable.

80041 UNIVERSAL CART



KAYAK CART "PLUG-IN" HOBIE TRAX "2-30"

All of the great features of a Trax 2 cart with **higher capacity!** The Trax "2-30" cart has 30 cm tires, bringing the capacity up to 242 lbs. Even with a lighter load, the Trax 2-30 will be the best plug-in cart for sand.

80043001 TRAX "2-30" CART

**Note Tandem Island use issue*

**Note: Plug-in cart use on a Tandem Island requires add-on cart cradle #80044202 to disperse load*



MINI KAYAK CART

An easy way to pull your kayak around. Durable and lightweight, it simply straps on to the hull and off you go. Stores neatly in your hull's cargo bay while you're paddling. Best on smooth surfaces, not all-terrain.

72080 MINI CART



80044202 CRADLE FOR PLUG-IN CART / TI USE

Cart and Dolly warnings: Do not over-load. Not for towing or for speeds faster than average walking pace. Not for long hauls or stairs. Check cart fit carefully to be sure tires do not rub hull, on scupper versions that the posts fit clear through to the cockpit. Not for prolonged use / storage. Incorrect use can damage or distort hulls.

HOBIE KAYAK DOLLIES

Full size dollies for the Adventure / Tandem Island or Pro Angler / Universal includes a hull / ama cradle, and a pull handle. Much stronger and easier to load and use than plug-in carts for larger, heavier models. Two different wheel styles allow for optimum performance on hard pack surfaces – or soft sand beaches. Choose beach wheels for use over soft sand or other surfaces. Choose the tuff tire if your launch surfaces are solid. The handle makes it easier to insert or remove the cart under the boat or pull along when un-loaded. The handle also acts as a "kick-stand" to keep the cradle upright during loading. The handle and wheels are easily removable for storage. The Pro Angler / Universal dolly will fit a wide variety of Hobie Kayaks including Pro Anglers, Outback and Oasis. Recommended maximum load equal to one Tandem Island without excess personal gear.

80046200 AI/TI DOLLY - WITH BEACH WHEELS
80046201 PA/UNI - WITH BEACH WHEELS

(72061001 Replacement wheel retainer pin)



80046200 AI/TI DOLLY DOLLY
 W/ 42 cm BEACH WHEELS

80046100 AI/TI DOLLY - WITH TUFF TIRES
80046101 PA/UNI - WITH TUFF TIRES

(72061001 Replacement wheel retainer pin)



80046100 AI/TI DOLLY
 W/ 38 cm TUFF TIRES



The handle helps you get the cart down to the boat. Handle is also easily removable for cart storage.



Lift the bow and slide the cart under



Leave the handle in place while moving the boat



Adjustable strap included to secure the boat onto the cart.



KAYAK TRAILERS These trailers are versatile platforms that can be used for any kayaks. Order the basic single or double trailer to carry one or more kayaks inverted on the crossbars (crossbar padding / cradles shown are not included with trailers). Trailers ride on 8" wheels and use a 1 7/8" coupler. Trailers are certified to USA DOT standards for use on USA roads.

For the Adventure Island, Tandem Island or Pro Angler, add the optional custom designed hull cradle sets (Adventure Island cradles shown to right on double trailer). These are form fitted and foam covered. For two Adventure Islands, order the double trailer (Double-Double for two Tandem Islands) add two cradle sets and the optional center Tower System. The Tower includes mast / sail hangers and is also designed to mount an equipment box on top. Easily mount the Hobie Toy Box on top of the Tower.



38652000 SINGLE

(1 7/8" Ball)



*Trailer shown with Adventure Island cradles option

NOTE: Loads may require a red warning flag if over hanging lites by over 4 feet.

38652000 TRAILER - SINGLE AI / PRO A 12,14
Shown above with AI cradle set option (#72020400) Order cradles separately.
(Crossbars 42" Rear - 25" Forward / 15' 2" assembled length / 220 lb Capacity).

38652001 TRAILER - SINGLE TI / Pro A 17T
(52" Crossbars / 15' 6" assembled length / 350 lb Capacity) . Order cradles separately.

38652200 TRAILER - DOUBLE
Shown above with 2 AI and cradle set options (#72020400) and (#38652210) tower system.
(84" Crossbars / 16' 1" assembled length / 550 lb Capacity). Order cradles separately.

38652201 TRAILER - DOUBLE / DOUBLE
Not shown. Required to carry 2 Tandem Islands or one TI and AI side-by-side.
(96" Crossbars / 16' 1" assembled length / 550 lb Capacity). Order cradles separately.

38652210 TOWER
Add the optional tower for equipment box mounting on a double trailer, multi kayak transport (Up to 4 kayaks leaned against tower). Also includes two mast carriers for 2x AI/TI configuration.

Trailer prices DO NOT include freight to dealer or assembly costs. Thule storage box shown is not included and not available through Hobie Cat.



72020400 AI V2 CRADLES



72020402 TI CRADLES



72020401 PRO A 12/14 CRADLES

- 72020400 CRADLE SET** (1 boat) - ADVENTURE ISLAND V2 (>=2011 MODEL YR / Molded Plastic)
- 72020403 CRADLE SET** (1 boat) - ADVENTURE ISLAND V1 (<=2010 MODEL YR / FiberGlass)
- 72020402 CRADLE SET** (1 boat) - TANDEM ISLAND
- 72020401 CRADLE SET** (1 boat) - PRO ANGLER 12 / 14

(Cradle mount spacing 67" for proper fit / No fasteners included)

38653300 UNIVERSAL PAD SET - ALL OTHER KAYAKS



STORAGE BOX "TOY BOX"

Roto-molded seamless with molded-in graphics. Big enough to hold paddles, MirageDrives, Seat backs, Life Vests and wet wear and have room left for odds and ends. The bottom is ribbed to allow wet things to drain. There is full access from front and back. Mounting hardware is not included. Length 10' 4", Width (rear) 21", Depth (rear) 13", Width (front) 19 1/2", Depth (front) 10", Weight 55 lb.

1825WHT TOY BOX

Prices DO NOT include freight to dealer. Additional freight charges may apply.



ROOF RACK PAD

Beefy car roof rack pads, made from durable black polyester with Hobie diamond logo. Easy-on split bottom with Velcro™ closure.

- 72045 24" ROOF RACK PAD** (Pair)
- 72046 36" ROOF RACK PAD** (Pair)
- 72044 24" AERO RACK PAD** (Pair)
- 72049 36" AERO RACK PAD** (Pair)



QUICK STRAP SPORTRACK

Easily installs on any vehicle with front and rear doors or opening windows. The straps secure inside the car, no gutter hooks are required. Packed in mesh storage bag (#72040 with bow and stern tie downs).

72040 QUICK STRAP SPORTRACK (30" Pair)

72035 QUICK STRAP SPORTRACK (24" Pair / No Lines)



HOBIE TIE DOWN STRAPS

Rack tie-down straps, made of durable black polypropylene webbing. Diagonal cut and ironed ends make threading ends into buckles easier.

- 72042001 TIE DOWNS** 12' (Pair)
- 72043001 TIE DOWNS** 15' (Pair)

LOADING ACCESSORIES

by Rhino-Rack will make your day so much easier!
Load a kayak on to your vehicle without having to lift the full weight.
Perfect for loading up solo or for car topping heavier boats.
Why struggle when you can have Rhino-Rack help!

UNIVERSAL SIDE LOADER

The Rhino-Rack Universal Side Loader assists you in loading your kayak, ladder, camping gear or other longer heavy items, onto your roof rack crossbars. Simply lift one end of your load onto the Rhino Universal Side Loader, then pivot your load onto your crossbars.



Be sure to tie down your load once it is safely on the crossbars using load rated fastening straps.

Features include:

Push button for quick release and easy storage; Crossbar clamps to suit all popular roof racks; Heavy duty storage bag; Support pole for loads greater than 44lbs (up to 132lbs) Integrated load stop prevents load from sliding off bar; foam padding for protection of your gear; Padding on the underside of clamps to protect vehicle roof; Fits all Rhino Aero, HD/ Euro, all Thule Square, Aero bar & Wingbar, Rola, Prorack and Whipstar

72040011 RHINO UNIVERSAL SIDE LOADER

NAUTIC KAYAK LIFTER

Is a complete system for easily loading and unloading sit on top kayaks. It is the only one on the market that has an 80kg (176 lb) load capacity, does not require any heavy lifting and a single person can operate it using the included winch.

Spend more time having fun on your Hobie! Simple setup and operation makes a day on the bay possible and load hassle free! This kayak loader system is a back saver.

The unit is designed to be neatly stored on the roof of your vehicle beside your kayak when not in operation.

Important Note: Designed to fit most roof rack systems with bar overhang with at least 100mm.

72040012 RHINO NAUTIC KAYAK LIFTER



T-LOAD HITCH MOUNT

The Rhino-Rack T-Load Hitch Mount is the perfect load carrying solution for long loads. Built tough from E coated Steel, the T-Load allows you to effortlessly load and transport your kayak. Mounting to a 2" hitch receiver or ball the T-Load features an adjustable tilt position.



A fitting kit is provided to attach your Rhino-Rack crossbars directly to the top of the T-Load and because we're top blokes we've also thrown in a non-slip mat to stop slippage when loading.

Features Include:

Single person use; Adjustable height & tilt position: Minimum height 950mm; Maximum height 1540mm; 1 x Rhino-Rack Aero crossbar; Rhino-Rack crossbar fitting; 1 x RTLK (Rhino-Rack T-Load Sling Kit); Non slip mat; Choose the version: 2" hitch receiver or 2" / 50mm Ball mount; 3 year warranty

72040013 RHINO 2" RECEIVER T-LOADER

72040014 RHINO 2" BALL T-LOADER





72054 HOBIE TANDEM ISLAND COVER SHOWN

UNIVERSAL KAYAK COVERS

Protect your kayak from the effects of the weather, UV rays, dirt, leaves and birds. We have chosen sizes to fit the entire line of Hobie Kayaks. These covers are easy to install or remove, fits over the hull (like a fitted sheet on a mattress). Straps and pull string adjust for a tight fit. Cross straps secure the cover on your hull for windy conditions. Heavy duty UV resistant canvas material in a neutral color for better aging. These covers fit over the hull when upright or upside down. To help prevent distortions to the hull bottom shape, Hobie recommends that our kayak hulls be stored upside down resting on the cockpit rails. This is also best for deflecting rainwater and prevents water pooling in the cockpit or on the cover. When planning to store a hull upright, be sure to properly support the hull bottom to prevent hull distortions.



72050 KAYAK COVER / 9'-12' 6"
(Lanai, Maui, Sport, Revolution 11, Kona-Tight, Quest 11)

72051 KAYAK COVER / 12'-15'
(Kona [Loose], Pursuit, Mirage Classic, Tandem, Oasis, Outfitter, Quest 13, Outback, Revolution 13, Pro Angler 12 & 14)

72052 KAYAK COVER / 14'-16'
(Adventure, Revolution 16, Tandem, Oasis, Odyssey)



72053 KAYAK COVER / 14'-16' 6"
(Wide - Adventure Island with amas folded against hull)

72054 KAYAK COVER / 16'-18' 6"
(Wide - Tandem Island with amas folded against hull and rudder removed / layed on deck)



RUDDER COVER ISLAND / TI

Rudder protection for 2011' AI and all Tandem Island Rudders. Red color helps for trailering visibility.

82420001 RUDDER COVER ISLAND / TI



ONE WRAP VELCRO®

Cut this double faced Velcro® product to length and wrap it around items, line or whatever you need to secure. One side is hook and the other a loop, so a single piece is all you need.

7904 ONE WRAP, PER FOOT



SHOCKCORD BALL TIES

Lashing equipment to your boat is quick and easy with this handy tie-down. Dozens of uses.

370 SHOCK CORD BALL TIES EA



MULTI STRAP SYSTEM

Hang your kayak for storage, use as bow and stern lines or use them as carrying handles. Multi purpose straps can be attached to the boat and adjusted for many uses. Made from durable black polypropylene webbing.

72041 MULTI STRAP (Pair)



HOBIE MIRAGE KAYAK RIGGING STAND

Originally designed for use as a demonstration platform at dealerships and boat shows. Our staff and dealers realized how great it is for use as a Hobie Mirage kayak rigging stand! Place your kayak at a comfortable height for preparation of gear or while mounting hardware. The kayak is bolted to the rack through seat scupper holes for a secure and stable platform. Move the rack and boat around easily using a set of plug-in wheels as shown (not included). Multiple options for wheel use depending on your needs. Wheels simply insert into drilled holes in the frame. The rack easily disassembles for flat storage. Not recommended for long term storage.

87363222 FLOOR STAND, MIRAGE RIGGING



TALIC SEAHORSE RACK

Portable storage for kayaks under 100 lbs. Made of corrosion resistant anodized aluminum. Can be used indoors or out. Raises your kayak up to accessible height for outfitting accessories, cleaning or just keeping it off the garage floor. Collapsible for storage.

72088001 31" TALIC SEAHORSE RACK

HOBIE HATCH LINERS

For Hobie Mirage Outback, Revolution and Quest. Hatch liners were originally created for the popular Pro Angler series, the forward hatch liner is a space to store gear or fish just inside the forward hatch lid. Keeps items from sliding forward or back inside the hull and keeps them up off the bilge. Now available for the Hobie Outback, Revolution 11 / 13 and Quest 11 / 13 (2013+).

HOBIE HATCH LINERS

- 72020041 OUTBACK
- 72020042 REVOLUTION 13 / 2013+ QUEST 13
- 72020044 REVOLUTION 11 / QUEST 11



REVOLUTION



OUTBACK



HOBIE GEAR BUCKET

Add a drop-in "tackle box" to your 8" Hobie Twist and Seal hatch. The Gear Bucket containers are 2 1/2" deep and hang on the hatch lip or can be slipped down into the hull so you can carry several. Keep one on the hatch lip for easy access. Closing the hatch presses the containers seal closed to ensure items stay in place. You can carry fishing tackle, spare parts, snacks, tools, sun screen, first aid supplies and more in these easily size-adjustable storage segments. Get the three pack with handy storage bag and pre-pack your fishing tackle for fishing different species. Be prepared when the fish start biting with easy access inside the hatch just in front of your seat.



- 71704001 HOBIE GEAR BUCKET
- 71706001 3 PACK WITH BAG (8" Hobie Gear Bucket)
- 71705001 BAG FOR 3 HOBIE GEAR BUCKETS



HOBIE 6" HATCH BAG

Add a drop-in bag to the 6" Hobie Twist and seal hatch. Kit includes required back-up ring with lip, screws and bag with drawstring. (Available for 6" hatch only)

- 5421 6" HOBIE BAG KIT



HOBIE GEAR BUCKET - DEEP

Add a drop-in "storage box" to your 8" Hobie Twist and Seal hatch. 5" deep bucket without dividers. Note: Does not fit Pro Angler Aft Hatch

- 71704021 HOBIE GEAR BUCKET - DEEP



PLANO® TACKLE BOX

Innovative up-latching fasteners and Dri-Loc® Seal ensure watertight storage.

TACKLE BOX SMALL - 10 adjustable dividers create 5-15 compartments. Clear/Yellow 9.13" x 5" x 1.25"
72020311 TACKLE BOX SMALL

TACKLE BOX MEDIUM - 15 adjustable dividers create 5-20 compartments. Clear/Blue 11" x 7.25" x 1.75"
72020321 TACKLE BOX MEDIUM

TACKLE BOX LARGE - 25 dividers create 3-28 compartments. Perfect box for extra long bulk storage. Clear/Red 14" x 9.13" x 2"
72020331 TACKLE BOX LARGE



HOBIE TWIST AND SEAL HATCHES

TWIST AND SEAL HATCHES have a better seal. The lids also hinge open, so you never lose the lid. Designed with a cork-screw-like mechanism for closure, a simple twist of the handle opens or closes the hatch. As the screw pulls down the hatch, you get a tight seal on the "O Ring" seal against the inner cylinder. The hatch seals around the edge of the cylinder and does not have to be held down against a flat surface to seal. This allows the hatch to seal even if the lid is partially open or tipped. Flip the handle into the recess to "lock" it closed. Available in 6" and 8" diameters.

These hatches are now standard equipment on all Hobie Kayaks.

*Retrofit kits include gaskets (and 2 ea #8031130 screws for the 8").

- 71701011 6" TWIST AND SEAL HATCH
- 71701001 6" TWIST AND SEAL RETROFIT KIT*
- 71701021 6" TWIST AND SEAL O RING
- 71321001 6" MOUNT GASKET
- 71702011 8" TWIST AND SEAL HATCH
- 71702001 8" TWIST AND SEAL RETROFIT KIT*
- 71702021 8" TWIST AND SEAL O RING
- 71331001 8" MOUNT GASKET



HOBIE RECTANGULAR TWIST AND SEAL HATCH

Hobie rectangular hatch gives access and options. Includes backing ring. The Horizontal hatch is stiff and strong as designed for standing-on / near the Pro Angler floor. Unique Hobie designed seal and flange lip drainage keeps water out. Add the optional tackle management tray that deploys two tackle boxes as you open the hatch or the drop-in hatch bucket for versatile small parts storage (both shown below).

- 71707001 HOBIE RECTANGULAR HATCH
- 71707002 FLANGE GASKET
- 8032121 SCREWS (REQ 14)



HOBIE RECTANGULAR HATCH ACCESSORIES

Add a drop-in "storage box" to your Hobie rectangular hatch or tackle management tray that deploys two tackle boxes as you open the hatch.

- 71709001 HOBIE RECTANGULAR BUCKET
- 71708001 HOBIE TACKLE MANAGEMENT

ROLLING DUFFLE/GEARBAG

Back by popular demand. Great travel bag. High volume allows you to bring it all!
80000R ROLLING DUFFLE/GEARBAG



- Durable waterproof fabric and welded seams
- Roll Top watertight clip seal
- Adjustable shoulder strap
- Floats to retrieve from water



HOBIE ROLL TOP DRY BAG

- B630808 ROLL TOP BLUE
- B630809 ROLL TOP YELLOW
- 10" diameter x 20"

HOBIE SMALL ROLL TOP DRY BAG

8" diameter x 14". This dry bag is built of tough materials. Seals tight to keep your stuff dry.
71703001 8" HOBIE DRY BAG



SEE BAG

Transparent 13 oz. vinyl bags make quick work of locating things. Great for organizing gear and personal stuff. Keep your food and spare clothes dry. Easy to carry or tie onboard. Its cylindrical shape will hold odd shapes such as cameras, binoculars, lunches, etc. without distortion of bag and resultant potential leakage.

- 72210T SEE BAG (8" x 14" 622 cu.in.)
- 72230T SEE BAG (11" x 19" 2200 cu.in.)



HOBIE eVOLVE POWERED BY TORQEEDO

Whether you're augmenting your MirageDrive or using the Hobie eVolve as your primary power source, this quiet and efficient electric motor will dramatically expand your horizons. Maybe there's a ripping tidal current or a series of fast-flowing eddies that you must negotiate before reaching that pristine shoreline. Maybe it's a bay that's always been a little too far to explore. Or maybe it's just been a long day and your tired muscles could use a break. Either way, the clean, quiet, eVolve system is there for you.

This tidy German-engineered electric motor kit fits any MirageDrive kayak and it comes with two mounting options—one midship, the other stern hung. With the Hobie eVolve, you can either maintain steady cruising speeds of two knots (motor only) for hours, or you can open the throttle for short sprints. Best yet, depending on your set-up, you can use the eVolve to augment your boat speed while also using your MirageDrive. And thanks to its cockpit-mounted Remote Throttle, you always know how much juice you have left in the system's 320 Wh Lithium-Manganese battery. Runtime estimated as 8 hr 20 min at 2.6 mph / 48 min full throttle.

If you thought the MirageDrive made kayaking sweeter, wait until you try the eVolve system. The eVolve offers increased battery capacity, longer range and solar charge / run capability. Life only improves with power.

72022030 EVOLVE v2 TORQEEDO MOTOR KIT - Kayak

72022040 EVOLVE v2 TORQEEDO MOTOR KIT - i Series

EVOLVE V2 KIT INCLUDES:

- Ready-to-go Mirage well-mounted Hobie eVolve v2
- All cables for the motor and throttle units
- All mounting hardware
- Assembly that integrates the motor with a Twist and Stow rudder*
- Sealed/Waterproof Lithium-Manganese high-performance battery 320 Wh (charger included)
- Remote throttle system displays speed and distance information generated by an onboard GPS unit
- Magnetic safety key
- Waterproof fittings and cable connectors
- Solar charging port
- Corrosion-resistant materials ensure durability and performance
- Lightweight power: Total weight of installed kit is 18 lbs (8.16 kg) or less, depending on the configuration



BOTH MOUNTS INCLUDED



MIRAGE WELL MOUNT

A clever option for mounting the eVolve motor package is to swap out your MirageDrive for this electric unit. Just slot the well-mounted Hobie eVolve into any MirageDrive kayak and instantly enjoy powered propulsion. Ready to use fresh out of the box, the Mirage-mounted eVolve weighs a scant 6.4 pounds—that's 0.2 pounds less than the MirageDrive—and is built to take years of exploration and adventure.

RUDDER MOUNT

For Twist and Stow rudders only. The rudder-mounted eVolve is the ultimate tool for extending your range and exploration. This slick system uses a lightweight assembly to easily integrate the eVolve motor with a Twist and Stow rudder. Pedal and motor; motor, or simply pedal. When off, the engine becomes your rudder or it can be brought on deck via the Twist and Stow controls. (The rudder mount option is not compatible with inflatable series, Island series or Pro Anglers)



LITHIUM BATTERY V2

A lightweight, 6.6-pound, 320 Wh Lithium-Manganese battery (11Ah at 29.6V) powers the system's featherweight Torqeedo motor. The battery is buoyant and completely waterproof, ensuring safety and there-when-you-need-it performance. Its built-in GPS unit generates pertinent information such as speed and range. Solar charge / run port.



REMOTE THROTTLE

While the outboard might be transom-hung, the driver doesn't have to sit astern thanks to our Remote Throttle, which attaches via a RAM mounting unit (included) to provide throttle control from your favorite seating position. The LCD screen displays all the trip info you need (such as speed and range) while you're underway. For safety, the unit features a magnetic key-to-throttle connection; break this magnetic connection and the motor immediately stops.

SOLAR PANEL

Add a solar charging panel to your eVolve v2 system. Can charge the battery or run the motor indefinitely at approximately 2 knots (with optimum sun conditions). Solar panel uses dedicated plug-in on the v2 battery. 23 Watts of power for charging in best sun conditions, Weatherproof, Marine-grade connection, Ultra Light Weight, Ultra Thin, Ultra Durable, Roll for easy storage, Easy to use, Tested in salt water, Stainless Steel Grommets, Stainless Steel Rivets, Custom Built for Hobie Cat, Made in the USA

72022133 EVOLVE v2 SOLAR PANEL 23w



Size Unrolled: 35.55" x 26.15"
 Size Rolled: 14.5" x 4.0"
 Cable: 10'
 Watts: 23 Watts
 Operating Amps: .75 Amps
 Operating Volts: 30 Volts
 Weight: 1.4 Lbs



LIVEN UP YOUR DAY ON THE WATER WITH THE HOBIE LIVEWELL!

HOBIE LIVEWELL

This live bait tank was designed with the serious fisherman in mind. From the tournament angler to the weekend warrior, inshore or off, this livewell is capable of handling almost every fishing situation imaginable! Water intake and discharge fit right into the existing scuppers in the cargo area. With a high-flow self-priming* Attwood pump, a 6 volt sealed gel cell battery, adjustable drain, and the capability of holding up to 8 gallons of water this tank can handle almost any creature that you can squeeze into it. Ready right out of the box! Just charge and go! (*requires forward motion in the kayak to prime pump)

Looking for somewhere to put those extra rods? No problem! Hobie has included three rod holders to make this livewell one of the most functional pieces of fishing equipment that you'll ever own. Three's not enough, you say? Well for those who are ready for anything, Hobie has left you enough room to attach two more! This is a must-have for every Hobie Angler.



FEATURES: Pump, On-off switch, 6 Volt sealed Gel Battery, Charger, Battery compartment with lid, Carry handle, Adjustable hold down straps, Twist-n-Seal access lid, Fully assembled / charge and go! Custom designed to fit the Hobie Mirage Outback (Newer model w/o cooler recess), Sport, Adventure, Revolution, Pro Angler (needs 7" down tube) and the Quest.

7202007 HOBIE LIVEWELL BAIT TANK

72020015 ROD HOLDER - LIVEWELL

(Additional rod holders include the required fasteners)

(Livewell replacement parts shown on page 33)

72021035 ADVENT ISL LIVEWELL ADAPTER KIT

Adapts position and intake system to fit LiveWell into a Hobie Adventure Island



HOBIE H-BAR

The H-Bar from Hobie adds utility and options to your Hobie Mirage Pro Angler. Designed with the stand-up angler in mind, the H-Bar not only provides standing stability, but a great support platform for entering and exiting your kayak. Use the H-Bar to pull yourself up and make a cast to feeding fish. Made from clear-coated anodized aluminum, the H-Bar is light, strong, and quiet so fish don't spook. Mount accessories on the H-Bar like fishfinders or rod holders or leave it clear for stand-up paddling. Add a stripping basket to the front for snag-free fly fishing. Cast further while you lean against the foam pad in comfort. With the removal of two pins the H-bar folds away in seconds, leaving your front hatch and cockpit area fully accessible. Now includes two strut lengths for a wider range of height adjustment.

84500111 HOBIE H-BAR / PRO ANGLER



FIGHTING CUP KIT VANTAGE CHAIR

Gimbled fighting cup holds your rod butt as you fight a fish. Take some of the load off your arms! Mounts directly to the Vantage chair. All required parts included.

72020066 FIGHTING CUP KIT VANTAGE CHAIR



HOBIE 3-PC SUP PADDLE

3-piece Stand Up Paddle is perfect for use on a Pro Angler / H-Bar. Breaks down and stows in the included bag with blade cover.

23015575-10 HOBIE 3 PC SUP
PADDLE 7.5 ADJUSTABLE



ADJUSTABLE H-BAR

Built with our dodecagon (12 sided) extrusion, the adjustable H-Bar will integrate with all H-Rail accessories for easy customization. The H-Bar adds utility to your fishing experience whether you're standing or using it as a mounting platform. It folds up when you need it and away when you don't. The aluminum extrusion is strong and lightweight for leaning against or holding on to while entering/exiting the boat or pulling yourself up from a seated to a standing position. Fully adjustable to fit a wide variety of kayaks. Includes H-RAIL clamps for mounting to PA17.
84500114 HOBIE ADJUSTABLE H-BAR

H-RAIL TACKLE BIN

Add more storage or hold more gear. Designed to hold fishing tackle boxes, the tackle bin also includes a removable tray, Bungee® retainers, and plenty of places to clip things to. Store tools and use it as a place to collect odds and ends that usually clutter your fishing area.
84623001 TACKLE BIN / H-RAIL



H-RAIL MOUNTING PLATES

Mount almost any accessory to the H-Rail using this universal mounting plate. It's durable, easy to drill through and flat on the top and bottom, allowing bolts, nuts and washers to fit snugly.
84622001 MOUNTING PLATE / H-RAIL



H-RAIL RAM® MOUNTS

Add your favorite accessories to RAM Mounts on the H-Rail using the 1" or 1.5" ball.
84620101 MOUNT 1" RAM BALL / H-RAIL
84620151 MOUNT 1-1/2" RAM BALL / H-RAIL



H-RAIL CUP HOLDERS

Always have your favorite beverage conveniently located and secure.
84621001 CUP HOLDER / H-RAIL



Adjust the clamp along the rail by releasing the lever, sliding the clamp to the desired position and closing the lever.

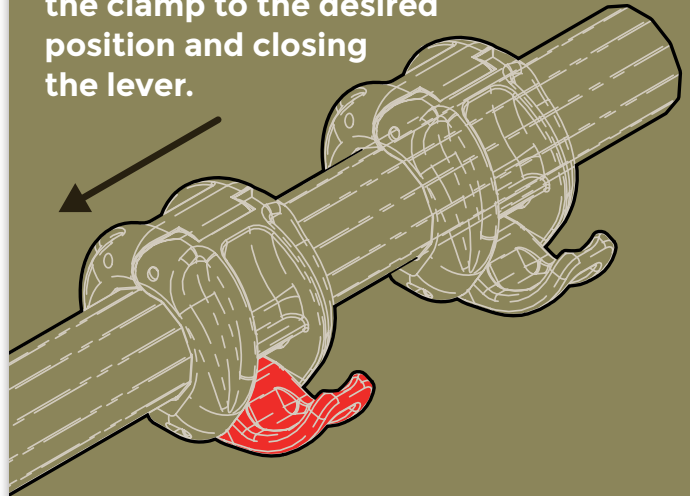

Adjustability is elementary.

Attaching, removing and adjusting H-Rail accessories is literally as easy as one, two, three.

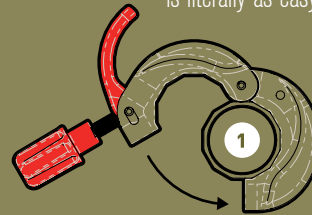

1. Wrap clamp around rail.

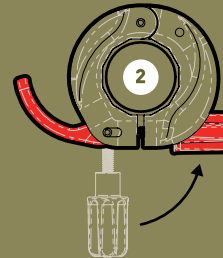

2. Latch gate and tighten.

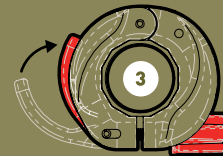

3. Close locking lever.

H-RAIL ROD RACKS

Designed for additional horizontal storage. Padding on the interior protects your investment, plus rod retainers secure your rods in position for easy access, surf landings or transport. When rotated, the Rod Rack can be used for storing other accessories like a paddle, sail or stakeout pole.
84625001 ROD RACK / H-RAIL



ROD HOLDERS / MOUNTS

HOBIE HORIZONTAL ROD HOLDER KIT

Keep your fishing rod secure and protected along the side of your kayak. Insert the rod tip into the tip protector and lock the rod handle into the clasp. Easy to install using the provided hardware. Choose either through-bolts or sheet metal screws. Fits any kayak. Patent Pending.
72021060 HORIZONTAL ROD HOLDER KIT



HUNTING



GUN MOUNT for your kayak.
 Mounts to kayak rail for easy access.
72020013 GUN MOUNT

SCOTTY ROD HOLDERS / MOUNTS

80048004
 ROD HOLDER
 W/DECK / SIDE MOUNT



80048001
 BAIT CASTER ROD
 HOLDER WITH DECK /
 SIDE MOUNT



80048005
 ROD HOLDER
 ROCKET
 LAUNCHER W/
 FLUSH MOUNT



80052001
 DECK / SIDE MOUNT



80055001 FLY ROD HOLDER
 WITH DECK / SIDE MOUNT

80049001
 FLUSH MOUNT

HOBIE MOLDED-IN ROD HOLDER EXTENSIONS

Keep your fishing rods secure and reels higher out of the water. These fit right into the molded-in rod holders and offer a larger diameter sleeve that is deeper. Leash the holder extension to the boat and the rod to the holder using the molded eyes.

72020014 ROD HOLDER EXTENSION



80048002 (LEFT)
ROD HOLDER HEIGHT
EXTENDER 8.5"

80048003 (RIGHT)
ROD HOLDER HEIGHT
EXTENDER 6.5"



80048006
GEAR HEAD
MOUNT



80048007
GEAR HEAD
TRACK ADAPTER

SCOTTY ROD HOLDERS

- 80048001** ROD HOLDER - BAIT CASTER W/ MOUNT
- 80055001** ROD HOLDER - FLY ROD W/MOUNT
- 80048004** ROD HOLDER WITH SIDE-DECK MOUNT
- 80048005** ROD HOLDER ROCKET LAUNCHER
- 80048006** GEAR HEAD MOUNT
- 80048007** GEAR HEAD TRACK ADAPTER
- 80048002** ROD HOLDER HEIGHT EXTENDER 8.5"
- 80048003** ROD HOLDER HEIGHT EXTENDER 6.5"
- 80052001** MOUNT - DECK / SIDE
- 80049001** MOUNT - FLUSH

ROD HOLDERS / MOUNTS

RAM is the revolutionary universal ball and socket mounting system that allows you to mount practically anything anywhere. Unlike other mounts on the market, RAM allows you to mount items where you need them most. If you need to mount a Rod Holder, GPS or FishFinder look no further. RAM mounts will help you make a professional job easy. Its unique design provides easy installation, mobility, strength, versatility, vibration protection and durability, all at a low cost. RAM is backed by a Lifetime Warranty which makes it the mounting system of choice. To provide light weight strength and corrosion resistance, RAM uses marine grade aluminum with a powder coated finish, light weight nylon injected molded plastic, stainless steel hardware and rubber balls.



72023013 RAM TUBE (PLASTIC) PIVOT ROD HOLDER (1.5")

72023030 RAM 2007 HOLDER RECTANGLE BASE 1.5"

72023023 RAM REVOLUTION HOLDER

72023014 RAM TUBE (PLASTIC) ROD HOLDER (1.5")

72023022 RAM TUBE (PLASTIC) PIVOT ROD HOLDER W/ FLUSH MOUNT

72023008 RAM FLY ROD HOLDER (1.5")



72023001 RAM
SMALL DIAMOND (1")



72023003 RAM 2 X 2.5 (1.5")



ACCESSORY TUBE
WEDGE MOUNT
(ALSO FITS SCOTTY)
1" or 1.5" BALL (1.5" Shown)
72023015 1.5" BALL
72023016 1" BALL



72023002
RAM SPACE SAVER (1.5")



72023025 U-BOLT 1-1.25" RAIL BASE
W/ 1.5" BALL



72023017 U-BOLT 5-1.25" RAIL BASE
W/ 1" BALL



72023029
RAM RAIL V-BASE
(STRAP 1" - 2.1") 1" BALL



72023028
RAM RAIL BASE
(STRAP .5" - 2") 1.5" BALL

*Great for
mounting on
Island akas!*

RAM CAMERA MOUNT



72023032
CAMERA MOUNT
18" ARMS (PAIR)



72023034
RAM GOPRO
MOUNTING BASE
1" BALL



72023033
RAM SMALL ROUND
BASE 1/4"-20
1" BALL

MOUNT TO 1.5" BASE
NOT INCLUDED

ADD CAMERA
ADAPTER BALL



72023019
RAM DBL 'B' 1" BALL SOCKET
ASSEMBLY



72023031
RAM X-GRIP



72023036
RAM 10" POST
EXTENSION
ARM 1.5"

- 72023001** RAM SMALL DIAMOND BASE 1" BALL
- 72023002** RAM SPACE SAVER BASE 1.5" BALL
- 72023003** RAM TUBE BASE 2 X 2.5
- 72023008** RAM FLY ROD HOLDER W/ BASE
- 72023013** RAM TUBE (PLASTIC PIVOT) ROD H
- 72023014** RAM TUBE (PLASTIC) ROD HOLDER
- 72023015** RAM MAST-TUBE WEDGE MOUNT 1.5"
- 72023016** RAM MAST-TUBE WEDGE MOUNT 1"
- 72023017** RAM U-BOLT RAIL BASE w/ 1" BALL
- 72023019** RAM DBL 1" BALL SOCKET ASSEMBLY
- 72023023** RAM REVOLUTION ROD HOLDER
- 72023025** RAM U-BOLT BASE w/1.5" BALL
- 72023028** RAM BASE (STRAP .5" - 2") 1.5"
- 72023029** RAM V-BASE (STRAP 1" - 2.1") 1"
- 72023030** RAM 2007 HOLDER RECTANGLE BASE
- 72023031** RAM X-GRIP
- 72023032** RAM CAMERA MOUNT ARMS
- 72023033** RAM SMALL ROUND BASE 1/4"-20
- 72023034** RAM GOPRO MOUNTING BASE 1"
- 72023036** RAM 10" POST EXTENSION ARM 1.5"

ACCESSORY MOUNTS



GEARTRAC

Add a whole new level of versatility to your kayak with GearTrac from YakAttack! GearTrac makes your kayak not only adjustable, but fully configurable, enabling you to change your setup from one outing to the next. Trolling for kings today? Fly fishing tomorrow? Duck hunting next weekend? GearTrac gives you the ability to go from a fully rigged kayak fishing machine to a flat deck in minutes.

You'll never look at tracks the same way again. Of course you can attach to your kayak, but how about your milk crate? What about organizing your accessories in your truck or garage?

Take it to another level by attaching a YakAttack MightyMount to the back of the track (yes - we matched up the hole patterns). Attach a Screwball to the MightyMount and your GearTrac becomes a fully articulating, remote platform.

72020057 GEARTRAC-8", 2 PACK W/ MOUNTING HARDWARE

72020058 GEARTRAC-12", 2 PACK W/ MOUNTING HARDWARE

72020059 GEARTRAC-16", 2 PACK W/ MOUNTING HARDWARE



SCREWBALL 1" OR 1.5"

THREADED RAM BALL AND MIGHTYBOLT™

Compatible with GearTrac System as well as other track systems. Attaches directly to MightyMount™

- 72020053** SCREWBALL, 1" , 1/2" MIGHTYBOLT
- 72020054** SCREWBALL 1-1/2", 1/2" MIGHTYBOLT
- 80048007** GEAR HEAD TRACK ADAPTER



MIGHTYMOUNT™

Use it to attach stuff to your kayak's track system. Use it as a standalone mount to secure your VISICarbon Pro™. Use it with the brand new Screwball™ or the Panfish™ camera pole. Whatever you do with your MightyMount™, you'll find it does the job. And it does it well. Oh yeah - the best part - it won't hurt your wallet either...

- 72020051** MIGHTYMOUNT W/ MOUNT HDWR
- 72020052** MIGHTYMOUNT SCOTTY KIT W/ HDWR

PANFISH CAMERA MOUNT

Getting your camera pointed in the right direction just got a little easier. The PanFish™ by YakAttack™ features a split mast design with adjustable friction disks that allow quick and easy horizontal panning. Just grab the foam grip above center mast and rotate. Nothing to loosen, nothing to get loose. Just point and let go.

The PanFish™ was designed for over-the-shoulder video with lightweight cameras. We recommend a maximum payload of 1 lb, including camera and housing (if applicable). This covers most lightweight and point-and-click style cameras.

72020055 PANFISH POLE (W/O MIGHTYMOUNT)

PANFISH PORTRAIT

A picture says a thousand words, so keep it short and sweet with the PanFish Portrait™!

Designed for mounting in front of the paddler, the low profile of this full featured camera mount keeps it out of your way but readily available for trophy pictures or reverse angle video of the big fight.

The pivoting head can be positioned at any angle in the horizontal plane. This creates the perfect scenario for "hero" shots.

- 1) Rotate LCD towards you
- 2) Navigate your camera's menu to set the delay timer
- 3) Rotate lens towards you, pick up your fish before timer fires
- 4) Perfect hero shot!

This same process can be used for taking Catch-Photo-Release photos while holding the fish securely to the measuring board and getting your mug in the shot to boot!

The PanFish Portrait™ was designed for a maximum payload of 2 lbs, making it ideal for reverse angle video with "heavier" cameras.

72020056 PANFISH PORTRAIT (W/O MIGHTYMOUNT)



**IF YOU'RE A SERIOUS KAYAK ANGLER LOOKING FOR FAST AND SECURE ANCHORING POWER?
THE POWER-POLE MICRO IS FOR YOU!**

**FOR A HOBIE PRO ANGLER; POWER POLE, MOUNT AND POWER SUPPLY!
EASY AS... 1 - 2 - 3!**

(Mounting on a Pro Angler requires the Hobie mounting plate to properly distribute loads. Not approved for use on other Hobie models at this time)

1 - POWERPOLE MICRO AND SPIKE

Includes Micro Driver Unit and 8.5ft Spike. This all-electric unit is extremely quiet and easy to use. It works with a 3/4" spike to stop and anchor your kayak at the push of a button. It functions as a conventional stakeout pole or shallow water anchor without having to manually deploy it yourself. When the wind and water are moving, you won't be. With Power-Pole's signature strong hold, the Micro gives you a smooth stop on the spot in seconds. Whether you're anchored in sand, rock or mud - it's swift, silent, and secure.

72020083 POWERPOLE MICRO AND SPIKE



2 - POWERPOLE - PRO ANGLER MOUNT KIT

Attach a Power-Pole Micro to the stern of your Hobie Pro Angler using the hardware and mounting plate that comes in this kit.

72020176

3 - POWERPOLE - POWER KIT

Power up your Power-Pole Micro using this kit. Kit includes 12V battery, charger, battery holder, and all of the wire plugs, adapters and connectors.

72020076

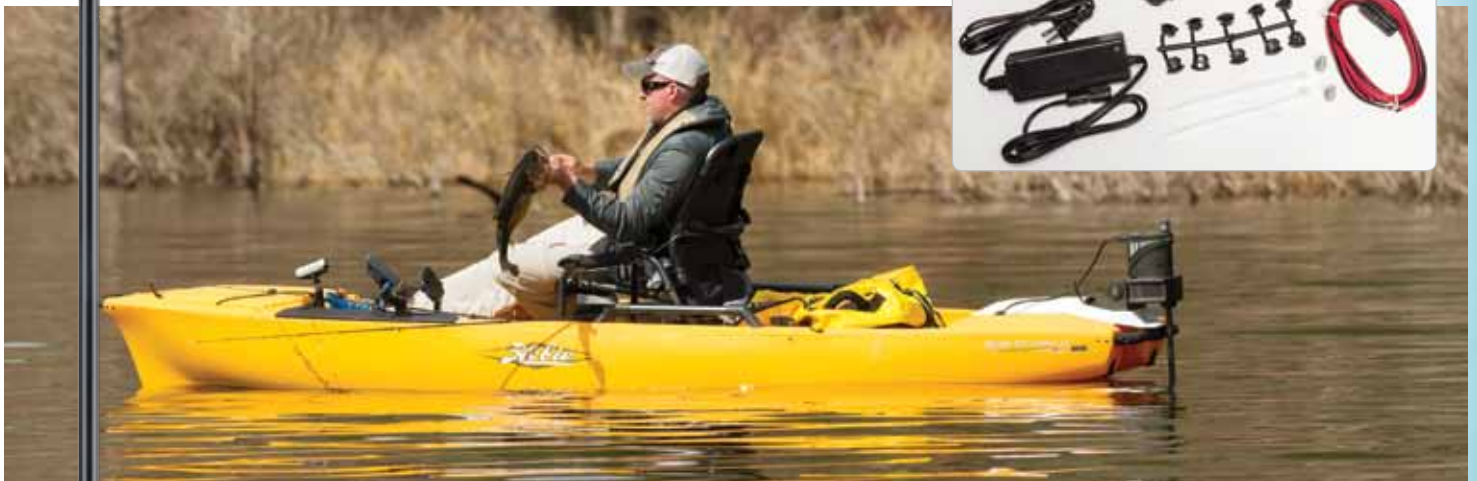

INDIVIDUAL PARTS / SPARES:

POWERPOLE MICRO ANCHOR MOTOR Micro Driver Unit includes wireless remote control, advanced wireless dash switch, mounting hardware, fully adjustable mounting bracket, electrical cord/plug/ battery terminals, quick release cord, free app (Android), USB Connector, and Bluetooth

72020084 POWERPOLE MICRO ANCHOR MOTOR

SPIKE 8.5ft tall 3/4" spike

72020085 8.5 ft. SPIKE - POWER POLE MICRO

MOUNT PLATE For Pro Angler 12/14

72020177 POWERPOLE - MOUNT PLATE ONLY

HOBIE STAKE-OUT POLE

Hold position in shallow water by inserting the Hobie Stake-Out Pole into sand or mud. Fiberglass pole with metal tip, rubber grip handle and attachment line system. (Connect to the Hobie Anchor Trolley System for best results)
72076001 STAKE-OUT POLE



RAM MOUNTS AND LOWRANCE ELECTRONICS

See mount and electronics pages for details.

RAM TUBE ROD HOLDER
 72023000

LOWRANCE ENDURA 72020018
 RAM MOUNT 72023018



ANCHOR KIT

3.5 pound folding anchor, bag and 60 feet of line. (Connect to the Hobie Anchor Trolley System for best results)
80035A ANCHOR



HOBIE DRIFT CHUTE

Large cone shaped "para" chute deployed in the water slows your drift in windy conditions when anchoring is not possible or desired. Design keeps chute just under the surface and fully inflated. Anchor line not included. (Connect to the Hobie Anchor Trolley System for best results)
72020009 DRIFT CHUTE



HOBIE ACCESSORY PACKAGES

The "Easy Button!" Basic combinations of accessories that work. Designed to give you what you need all in one package. Choose fishing, safety, performance or transport.



72020021 ULTIMATE KAYAK FISHING PACKAGE

- 1 72020020 FISH FINDER PACKAGE
- 1 71706001 HOBIE GEAR BUCKET 3 PACK
- 1 72023014 ROD HOLDER - RAM TUBE
- 1 72020073 ANCHOR TROLLEY KIT
- 2 72020014 HOBIE ROD HOLDER EXTENSIONS
- 2 74052001 HOBIE ROD LEASHES



72020020 FISHFINDER PACKAGE

- 1 72020089 FISHFINDER - LOWRANCE ELITE-3X
- 1 72023024 FISHFINDER MOUNT - RAM MOUNT III
- 1 72020039 FISHFINDER INSTALLATION KIT II



72020022 KAYAK FLY FISHING PACKAGE

- 1 72023008 FLY ROD HOLDER - RAM
- 1 72063101 SIDEKICK AMA KIT (DARK GREEN)
- 2 72020001 HOBIE GEAR KEEPER LARGE 36"



72020024 MIRAGE PERFORMANCE PACKAGE

- 1 72066001 V2 ST TURBO FIN KIT
- 1 81397001 LARGE TWIST AND STOW RUDDER



72020023 KAYAK CUSTOMIZATION PACKAGE

- 1 71115101 TOOL, SCREW-IN FITTINGS
- 5 71117001 CLEAT
- 5 71116001 PAIDEYE

HOBIE LIVEWELL

This live bait tank was designed with the serious fisherman in mind. From the tournament angler to the weekend warrior, inshore or off, this livewell is capable of handling almost every fishing situation imaginable! See Livewell on page 22 for more details.

72020007 HOBIE LIVEWELL

72020015 ROD HOLDER - LIVEWELL

(Rod holders include needed fasteners)



ROD HOLDER EXTENSION
72020014

HOBIE ROD HOLDER EXTENSIONS

Keep your fishing rods secure and reels higher out of the water. These fit right into the molded-in rod holders and offer a larger diameter sleeve that is deeper. Leash the holder extension to the boat and the rod to the holder using the molded eyes.

72020014 ROD HOLDER EXTENSION



HOBIE ROD LEASH

Keep those nice fishing rods from swimming away. Secure the rod leash to boat and rod. Quick snap connection feature allows easy detachment when needed. Webbing construction with quick connect hook.

74052001 ROD LEASH - WEBBING

HOBIE ANCHOR TROLLEY KIT

Easily deploy your anchor, drift chute or stake out pole over the side of the cockpit area, then move the attachment position forward or aft to hold your boat in the position desired. Easily sit facing down stream / wind at anchor. Simple pulley system and cleat allows adjustment all along one side of your boat anywhere from bow to stern. PA 12 and 2013+ PA 14s are "Trolley Ready" with molded-in fittings to mount the turning blocks.

72020073 ANCHOR TROLLEY KIT - UNIVERSAL

FISH GRIP

Handy fish grip in a glow-in-the-dark plastic material.

72020019 FISH GRIP



72020025 KAYAK TRAVEL PACKAGE

- 1 72046 ROOF RACK PADS - 36"
- 1 72042 TIE DOWN STRAPS
- 1 80045001 KAYAK CART "PLUG-IN" STANDARD



72020026 KAYAK SAFETY PACKAGE

- 1 72020010 HOBIE SAFETY KIT
- 1 72020002 SAFETY FLAG
- 1 72020003 HYDROSTAR LIGHT



72020029 DELUXE KAYAK SAFETY PACKAGE

- 1 72020010 HOBIE SAFETY KIT
- 1 72020040 VISICARBON SAFETY FLAG / LIGHT
- 1 72020032 BILGE PUMP



72020000

72020001

HOBIE GEAR KEEPER

Keep your equipment where you left it; safe and onboard with the Hobie Gear Keepers. These low force retractor tools are ideal for gear such as pliers, dykes, lipper tools etc.

72020000 SMALL HOBIE GEAR KEEPER

Features: 36" 50lbs Breaking Strength Spectra Nylon Line, Plastic Snap Clip, 3/8" Quick Connect Split Ring.

72020001 LARGE HOBIE GEAR KEEPER

Features: 36" 60 lbs. Breaking Strength Nylon Coated Stainless Steel Cable, Stainless Steel Spring and Hardware, Plastic Snap Clip.

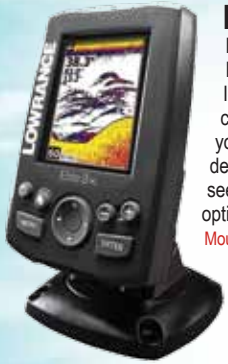

ELITE-3X FISHFINDER

Lowrance® offers their most affordable color fishfinder featuring Broadband Sounder™, water-temperature sensor and Fish I.D. Comes standard with a dual-frequency transducer that can be used at 83kHz or 200kHz to maximize the view beneath your kayak. It features a bright, LED-backlit color display with detailed 320x240 resolution and automatically adjusts settings to see fish, structure and bottom detail more clearly. The Fish I.D. option easily identifies fish locations and depths. (Hobie Recommends Mount 72023024 & Install Kit 72020011, 72020039 or 72020070) 72020089 ELITE-3X



ELITE-5 CHIRP FISHFINDER/GPS

5-inch fishfinder/chartplotter that combines CHIRP Sonar with DownScan Imaging™, built-in GPS antenna and detailed U.S. mapping. The Elite-5 CHIRP includes all of the proven features launched with the highly successful Elite-5 HDI with the addition of CHIRP sonar technology —providing greater sensitivity, improved target resolution and superior noise rejection for clearer, easy-to-see bait fish and game fish targets. Comes with 83/200kHz + 455/800kHz transducer standard.

(Hobie Recommends Mount 72023024 & Install Kit 72020039 or 72020070) 72020035 ELITE-5 CHIRP



MARK-4 HDI FISHFINDER/GPS

Affordable grayscale fishfinder/chartplotter that uses the best in fishfinder technology. With Hybrid Dual Imaging (HDI), finding key structures in shallow and deep waters has never been easier. Never miss a key piece of structure using the TrackBack feature on the built-in GPS, which is compatible with Insight Genesis sonar data recorder and all Lowrance mapping options for customized contour maps, downloadable onto any computer. Comes standard with a dual-frequency transducer that can be used at 83kHz or 200kHz to maximize the view beneath your kayak. (Hobie Recommends Mount 72023024 & Install Kit 72020011, 72020039 or 72020070) 72020086 MARK-4 HDI



ELITE-7 CHIRP FISHFINDER/GPS

7-inch fishfinder/chartplotter that combines CHIRP Sonar with DownScan Imaging™, built-in GPS antenna and basemap. The Elite-7 CHIRP includes all of the proven features recently launched with the highly successful Elite-7 HDI with the addition of CHIRP sonar technology -- providing greater sensitivity, improved target resolution and superior noise rejection for clearer, easy-to-see bait fish and game fish targets. Comes with 83/200kHz + 455/800kHz transducer standard. (Hobie Recommends Mount 72023038 & Install Kit 72020039 or 72020070) 72020091 ELITE-7 CHIRP



ELITE-4 HDI FISHFINDER/GPS

Power packed fishfinder/chartplotter with all of the same great features that make Lowrance the number one choice amongst kayak anglers. Both Broadband and DownScan Imaging technology can be used simultaneously for pin point accuracy underwater and detailed mapping with TrackBack to maintain position above water. Built-in GPS is compatible with Insight Genesis sonar data recorder and all Lowrance mapping options for customized contour maps, downloadable onto any computer. Comes with an 83/200kHz + 455/800kHz HDI transducer standard. (Hobie Recommends Mount 72023024 & Install Kit 72020011, 72020039 or 72020070) 72020080 ELITE-4 HDI



HDS-7 GEN2 TOUCH FISHFINDER/GPS

High-definition, 7-inch, widescreen color display with touchscreen functionality for fast and easy operation. Built-in StructureScan™ HD sonar imaging, plus award-winning Broadband Sounder™ with DownScan Overlay™ and TrackBack™ feature. Personalized or built-in Insight mapping and optional Navionics® charts. View both at once in 3D perspective view, plus StructureMap™, Broadband Radar™ and SIRIUS® weather overlay capability. Brilliant, enhanced SolarMAX™ PLUS display for superior sunlight and wider-angle viewing. Single Ethernet port and one full-sized SD card slot.

(Hobie Recommends Mount 72023038 & Install Kit 72020039 or 72020070) 72020069 HDS-7

Note: Lowrance Warranty is handled directly by Lowrance. Refer to documentation included with these products.

All FishFinders include Lowrance standard base, transducer and cables. Find detailed descriptions and specifications for these Lowrance products at <http://www.lowrance.com/>

FISHFINDER MOUNTS BY RAM



FISHFINDER MOUNT I

FITS LOWRANCE X4-Pro, X67C, M68C; HUMMINBIRD PIRANHA MAX 10, 15, 20; EAGLE CUDA 2401, 240, 168, 128, FISHEASY 320C, FISHEASY 240 72023007



FISHFINDER MOUNT II

FITS LOWRANCE MARK, ELITE SERIES AND HUMMINBIRD 100, 300, 500, MATRIX SERIES 72023021



FISHFINDER MOUNT III

FITS LOWRANCE MARK, ELITE SERIES (1" RAM BALL) 72023024



UNIVERSAL ELECTRONICS MOUNT

72023006 RAM 1" BALL UNIVERSAL DIAMOND BASE 6 1/4 X 2 (SHOWN)

72023038 RAM 1.5" BALL UNIV MOUNT 6 1/4 X 2 COMPOSITE

FISHFINDER INSTALLATION KITS

FISHFINDER INSTALLATION KIT I

Hobie has taken the guess work out of installing a fishfinder by providing a simple yet complete installation kit. This kit is adaptable to virtually any kayak and will run most fishfinders on the market, like our Lowrance Compact Series fishfinders. The only thing you need to do is determine the location of your new unit! Kit includes: Dry Bag, Battery Harness, AA Batteries, Snap Connector, Foam Transducer Pad, Zip Ties, Marine Goop, Displacement Connectors, Rubber Grommet.



72020011 FISHFINDER INSTALL KIT I

FISHFINDER INSTALLATION KIT II

Hobie's full size fishfinder installation kit integrates a waterproof 9AH gel cell 12-volt battery to provide more power to run larger units like the Lowrance Full Size Series of fishfinders. It can also be used to run smaller units for longer periods of time. Kit includes: Waterproof 9AH gel cell 12-volt battery with attached waterproof wiring and connectors, 12-volt battery charger, Hobie battery holder, foam battery pad, foam transducer pad, zip ties, marine goop, wire connectors, rubber grommet, wire cap.



72020039 FISHFINDER INSTALL KIT II

FISHFINDER INSTALLATION KIT III LOWRANCE® READY

This kit is specifically pieced together to include everything you need for wiring up your fishfinder to any Hobie kayak with the "Lowrance Ready" feature. Kit Includes: 12V 9AH waterproof gel cell battery and charger, wiring hardware, and battery holder which mounts to the sail post or in the lip of an 8" twist and seal hatch.



72020070 FISHFINDER INSTALL KIT III

Fits 1" Ball

RAM TRANSDUCER ARM MOUNT

Compatible with all transducers which attach using a 1/4" bolt. An 18" rigid aluminum rod can be bent to position your transducer to its optimum location. Patented socket technology allows for quick raising, lowering, removal and stowage of transducer arm. Transducer not included with purchase.

72023035 RAM 18" MOUNT TRANSDUCER

72023037 RAM 18" MOUNT STRUCTER SCAN 1&2

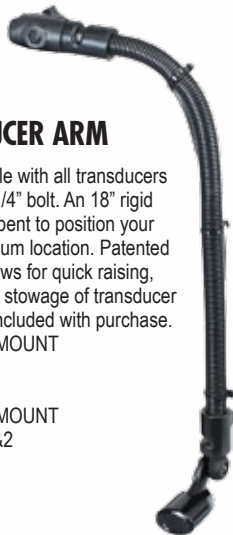

RITCHIE PANEL MOUNT COMPASS

When you're miles out to sea or simply trying to navigate your way through uncharted waterways, rest assured that you can make it back home with one of the worlds most innovative panel mounted compasses.

72020004 RITCHIE COMPASS PANEL MNT X-21



HOBIE 12V BATTERY HOLDER

Note: Wires and batteries shown are not included with mounts.



Hobie's battery holder is versatile! Hang inside an 8" Twist and Seal hatch or mount to the mast / accessory receiver inside the hull. Includes both options in one.

72025007 HOBIE 12v BATTERY HOLDER

72025001 HOBIE 12v BATTERY

72025002 CHARGER - HOBIE 12v BATTERY

HOBIE THRU HULL WIRING KIT

Hobie thru hull fittings for routing wiring through cockpit area for FishFinders, GPS and more. Includes two through hull fittings with backing nuts, o-rings and one "tree" of adapters for different wire diameters.

86505621 HOBIE THRU HULL WIRING KIT

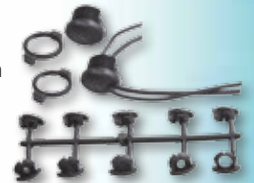

ELEC CONNECTOR SET

Set of male / female waterproof plugs with wires and 4 waterproof (silicone filled wire nut) connectors.

72021027 ELEC CONNECTOR SET



72025005 (1) SILICONE FILLED WIRE NUT

72021011 SPARE TRANSDUCER PAD

72025004 SPARE BATTERY PAD

72021015 MARINE GOOP

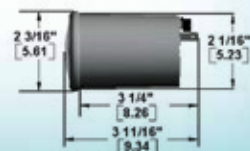



BOW SHACKLE - THREADED PIN

Part #	Pin Dia.	Width	Length	Max Ld#
SP150061	1/4"	9/16"	15/16"	4400



"D" SHACKLES - THREADED PIN

Part #	Pin Dia.	Width	Length	Max Ld#
SP150041	5/32"	3/8"	5/8"	1100
SP150051	3/16"	1/2"	11/16"	2640
SP150052	3/16"	5/8"	15/16"	2640
SP150053	3/16"	5/8"	1 7/16"	2640



SAFETY SHACKLE WITH 1/2 TURN CAPTIVE PIN

Part #	Pin Dia.	Width	Length	Max Ld#
SP185205	3/16"	1/2"	1"	2640
SP180005	3/16"	5/8"	1 7/16"	2640
SP180006	1/4"	7/8"	1 5/8"	4400



TWIST SHACKLE WITH 1/2 TURN PIN

Part #	Pin Dia.	Width	Length	Max Ld#
SP170005	3/16"	1/2"	7/8"	2640
SP170006	1/4"	9/16"	1 3/8"	4400



FAST SHACKLE

Avibank ball lock pin permanently wired to the shackle so it won't drop in the drink when released.

3062 EACH



HARKEN 16MM AIR BLOCKS

Harken's newest small blocks for control lines. Accepts up to 7/32" line, 900 pound load, 5/8" sheave diameter. Ultra light weight.

- H404 SINGLE
- H405 SINGLE w/ BECKET
- H406 DOUBLE
- H407 DOUBLE w/ BECKET



H082



H083



H092



H166



H167

HARKEN BULLET BLOCKS

Medium size blocks that work well for control lines. Accepts up to 5/16" line, 2000 pound load, 1 1/8" diameter sheave.

- H082 SINGLE
- H092 CHEEK
- H166 SINGLE w/ SWIVEL
- H167 SINGLE w/ SWIVEL & BECKET



H224



H233



H225

HARKEN MICRO BLOCKS

Small blocks with high load capabilities, but light weight. Accepts up to 1/4" line, 1200 pound load, 7/8" diameter sheave.

- H224 SINGLE
- H225 SINGLE w/ BECKET
- H233 CHEEK



REMOVABLE SHEAVE BLOCK

Simply remove the clevis pin that acts as the sheave axle, slide the sheave out of the frame, place the frame through the fitting and reinstall the sheave.

3103 EACH



SUPER STRETCH SHOCKCORD

This midnight-black shockcord has double the stretch of ordinary cord. If you've been getting your shockcord from the hardware store, you're in for a treat. The durable black cover is woven around an extra-flexible rubber core.

- RS018BLK 1/8"
- RS316BLK 3/16"
- RS014BLK 1/4"
- RS516BLK 5/16"
- RS038BLK 3/8"
- RS716BLK 7/16"

- 53180011 3/8" HOG RING
- 21180000 1/2" HOG RING



SUPER LOW STRETCH LINE

Pre-stretched polyester line with superior fatigue and abrasion resistance. Our line (3/16"-3/8") tested as the lowest stretch (.5%) of any all polyester line available. Sold per foot.

- RH112WHT 1/12" WHITE
- RH018WHT 1/8" WHITE
- RH316WHT 3/16" WHITE
- RH014WHT 1/4" WHITE
- RH516WHT 5/16" WHITE
- RH038WHT 3/8" WHITE

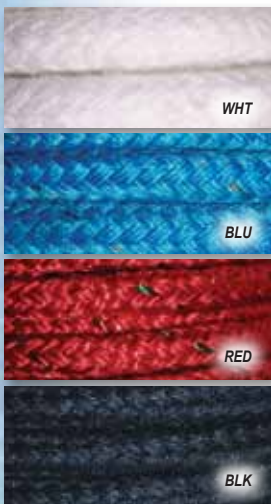

SPUN DACRON

Soft matte finish rope. Runs well thru blocks and fairleads, has good abrasion resistance, is spliceable and easy to hold with wet hands. Available in white, black, red, blue. This rope is not designed for winching. Sold per foot. Specify color choice.

- (White, Blue, Red or Black xxx = color)
- RM014WHT 1/4" WHITE
- RM014XXX 1/4" COLOR
- RM516WHT 5/16" WHITE
- RM516XXX 5/16" COLOR
- RM038WHT 3/8" WHITE
- RM038XXX 3/8" COLOR
- RM716WHT 7/16" WHITE
- RM716XXX 7/16" COLOR

SPECTRA

Rudder Steering and Up / Down control line .

- 81023001 SPECTRA 1.75 mm



SHOCKCORD SNAP HOOKS

Easy to install shockcord snap hook. No tools required. Reusable!

- 2101 HOOK-1/4"
- 2102 HOOK-5/16"

CLEATS



HARKEN CAMMATIC CLEAT

Rounded jaws assure quick cleating/release action and smoother teeth mean longer life for your lines.

H471 MICRO CLEAT, CARBO JAW
1/8" TO 1/4" LINE



HARKEN WEDGES

Fairleads and eyestraps designed specifically for each Cammatic, the wedges put the Cammatic on a 15 degree angle for ease of cleating or releasing. The fairleads are molded into a replacement base. The eyestraps are designed to be held in place over the cam by the mounting screws.

H297 WEDGE KIT
H284 WIRE FAIRLEAD
H281 EYE STRAP



SILICONE SPRAY

Dry silicone spray for sail luffs, cleats and bearings.

5106 SILICONE 11.5oz.



CLEAR SILICONE SEALER

Make sure your hulls are watertight! Clear Silicone seals leaks around all thru-hull fittings.

376 1.5oz. TUBE



AQUASEAL MIRAZYME ODOR ELIMINATOR

There's nothing quite like the odor of damp gear left in your car trunk for a couple of days. With one application eliminate those odors from booties, wet-suits, dry-suits and the rest of your gear. A 100% biodegradable product made from a blend of 10 highly specialized, light activated microbial elements. Works by penetrating into pores of fabric, rubber and even hard surfaces to eliminate odor naturally.

7003 8oz.



MAGICA RUST REMOVER

Easily clean rust stains from fiberglass, plastic surfaces, metal parts or fabrics. Although metal parts are made from high quality stainless steel, machining tools often leave carbon particles imbedded in the metal surfaces.

This material can bleed a rust stain onto other surfaces. Magica simply dissolves the rust away.

1603 MAGICA GEL 8oz. BOTTLE

SAIL REPAIR TAPE

Don't get caught with your sails down! Extra strong, Rip Stop white tape for temporary on-the-spot repairs to torn sails, canvas, even foul weather gear. Keep a roll in your toolbox for emergencies.

1662 2' x 25' ROLL



HOBIE BOAT CLEANER & UV PROTECTANT SYSTEM: CLEAN AND THEN PROTECT!



HOBIE BOAT CLEANER – 12oz

Formulated with "Green Chemistry" to safely remove dirt and stains from Hobie products. Good on fiberglass, polyethylene, Vinyl (trampolines) and PVC (inflatable). Cleans the most stubborn stains off of hulls.

70050001 HOBIE BOAT CLEANER – 12oz.

HOBIE UV PROTECTANT – 12oz

Protect and rejuvenate fiberglass, polyethylene, vinyl and PVC materials. Spray on, the protectant absorbs into the material and leaves a UV protective layer. Reduce the loss of essential oils and deflect the sun's harmful UV rays.

70060001 HOBIE UV PROTECTANT – 12oz.



TEAR-AID

Each TEAR-AID® repair patch is made from an exceptionally tough, matte finish, abrasion resistant, elastomer that resists puncture and tearing. It is combined with an aggressive adhesive formulated for high bond strength to a variety of surfaces such as canvas, leather, rubber, nylon, most plastics, paints, aluminum, stainless steel, fiberglass, polyurethane, polyethylene, polypropylene, vinyl and vinyl coated. TEAR-AID® Type A and TEAR-AID® Type B provide a simple and easy method of patching holes and tears, as well as an excellent protective film solution.

72020030 TEAR-AID / TYPE A (POLY)

72020031 TEAR-AID / TYPE B (VINYL)

EACH PATCH KIT CONTAINS: (1) 3" x 12" TEAR-AID® Patch that cuts with scissors to any size, (1) 7/8" x 7/8" Patch, (1) 1 3/8" x 1 3/8" Patch, (1) 12" Reinforcement Filament for repairing tears at edges, (2) Alcohol Prep Pads, (1) Illustrated Instructions and a Product Repair List.

KAYAK RIGGING KIT - HARDWARE

Set of fasteners for rigging a kayak for fishing accessories. A custom selection of hardware chosen by the Hobie fishing experts. Includes stainless bolts, nuts, washers, well nuts and more. All packed in a handy Plano box. You can purchase any of the items separately. Purchase the kit and have it all, or pick and choose your own based on your individual needs. All included parts are listed below as well as many more in the numerical section of our catalog.

72020300 Kayak rigging kit

Item	Qty	Part	Item
1	1	72020311	PLANO BOX - KAYAK RIG KIT
2	12	8031191	SCREW 1/4-20 X 1-1/4 PHMS
3	12	8030111	SCREW 10-32 X 1 PHMS-P SS
4	12	8030251	SCREW 10-32 X 1" FHMS
5	12	8030161	SCREW 10-32x1 1/2 RHMS-P SS
6	18	8080701	WASHER 1/4 X 1 SS HP
7	24	8080731	WASHER #10 FNDR SS
8	12	8050111	NUT 1/4-20 HX NYLOCK
9	24	8050201	NUT 10-32 NYLOCK LOPRO
10	12	8050221	NUT (WELL NUT) 10-32 x1
11	8	71110001	PAD EYE-BLK NYLON-3/8"
12	18	81029	LINE HANGER
13	8	78510001	BUNGEE HOOK

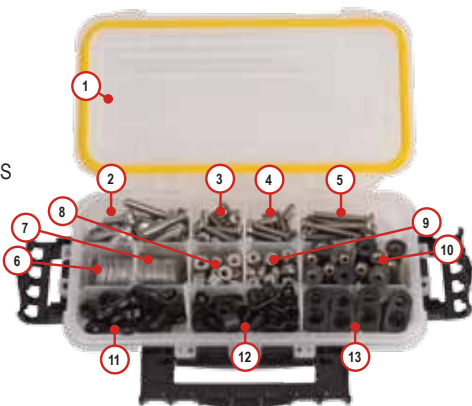

Extra rod stock available at no charge

KC WELDER PRO WITH HOBIE COLOR ROD STOCK

80 Watt element, flat tip and a 3/16" hole in tip for rod insertion. Includes a selection of Hobie color welding rod. Fix holes and cracks or customize polyethylene products. Insert the rod into the tip and place against the product to be welded. The tip heats the plastic surface and the rod. As the materials melt, move the tip along the repair area while pushing the rod into the tip to fill the repair area with new plastic material. Plug small holes after moving accessories. Rebuild keels after excessive wear from dragging.

72097001 KC WELDER PRO



STAINLESS STEEL POCKET KNIVES

STANDARD - Marlin spike and single blade. 3.5 oz.

1550 STANDARD

DELUXE - Marlin spike, knife blade, shackle tool, and screwdriver. 4.0 oz.

1551 DELUXE

YACHTSMAN - Marlin spike, blade, shackle tool. 2.0 oz.

1555 YACHTSMAN



HOG RING PLIERS

Cinch rings, hog rings, upholsterers clamp. They are all the same and these are the pliers to crimp them with. Use them on shockcord.

83104 EACH



GERBER NEEDLENOSE MULTI-PLIER®

Since 1939 Gerber has produced high quality innovative products for the outdoors. Features included in this model are; needlenose pliers, wire cutter, crimper, standard/metric scale, lanyard ring, cross head screwdriver, bottle/can opener, serrated sheeps foot blade, large, medium, and small flathead screwdrivers, file, drop point blade, and it adapts to the Gerber Tool Kit! This Multi-Plier® comes with the S.A.F.T. PLUS™ System where each component opens independently of all others, locks tightly against a positive stop roll bar and stays tight until you unlock it. Stainless steel construction with a limited lifetime warranty!

83102 GERBER TOOL



74050001

74051001

PADDLE LEASH

Secure paddle to your boats bow eye. Keep the paddle with the boat after a capsized. By holding the paddle after a capsized you can also be sure that the boat stays with you and cannot drift away. Web paddle leash is made from hollow webbing and an internal shock cord. Coil leash is elastic plastic coil.

74050001 PADDLE LEASH - WEB 4.5'

74051001 PADDLE LEASH - COIL

TECH TIP!

"WELL NUT" FASTENERS are tubular rubber fittings with an imbedded brass nut in the base. These are similar to a molly screw commonly used in sheet rock. They expand within the structure and give you a virtual backing nut and washer in an area that is inaccessible. Well nuts can be used for mounting many accessories to kayaks. Simply drill a hole as a net-fit dimension for the well nut. Insert the nut and position the hardware to be fastened. Insert and thread in the screw. Tighten until very snug. The brass nut is drawn up against the inside surface of the kayak which expands the rubber to a dimension that is too large to pull through the hole.



HOBIE SUNGLASSES

Hobie® Polarized Sunglasses are designed to improve your vision by eliminating glare, a problem that has been around since the first sunrise. Once you wear Hobie sunglasses you will never want to be without them! By cutting all glare, Hobie sunglasses make it easier to see the wind on the water, the fish in the water and any obstacles in your way. When you put on Hobies it's like a vacation for your eyes! See the complete line of Hobie Sunglasses at hobiepolarized.com

Escondido- 1565BLK



HOBIE CROAKIES

Keep your glasses in place! Made from wetsuit fabric that will not stretch or lose shape when wet. Remains secure whether worn normally, raised or lowered around your neck. 1553CR Each

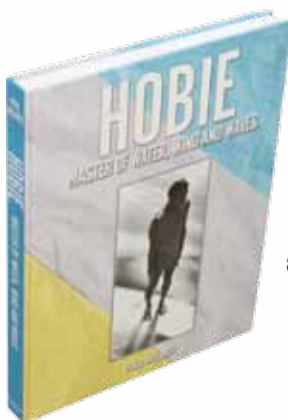

HOBIE-MASTER OF WATER, WIND, AND WAVES

The man, Hobie, known by just one name worldwide, has an epic life story. This 12" x 9" hardcover book shows how it all came to be, and more, in 17 chapters with 300 pages, 120,000 words of text and 585 photographs and illustrations. The book is available through Hobie Cat and Hobie Kayak dealers worldwide.

Surfboards, catamarans and boats, RC model airplanes (the Hobie Hawk), and a whole lot more "toys"—as Hobie himself describes his amazing life's work—will all be celebrated in the biography of the man who defined a lifestyle in surfing and sailing.

87369116 BOOK, HOBIE-MASTER OF WATER, WIND, AND WAVES



LICENSE FRAME "HOBIE"

3043 Chrome



LICENSE FRAME "KAYAKING"

3044 Chrome



STAINLESS WATER BOTTLE

71995001 20oz

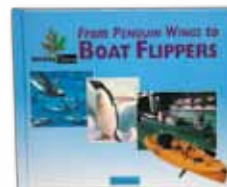

BOOK - FROM PENGUIN WINGS TO BOAT FLIPPERS

Great book about taking ideas from nature to use in products. All about the Hobie Mirage pedal system. Written by Toney Allman from the series "Imitating Nature". 615 Each



SPORTS BOTTLE

Show your Hobie spirit with the "just right" size sports bottle.

71999011 16oz

71997001 18oz

71998001 32oz

(Check parts pages for correct bottle fit)



HOBIE KEY FLOAT

Don't lose those keys! Keep a few bucks dry, inside the small compartment, while on the water. 72010 Each

STICKERS See Parts List for Pricing



12451050 / 12451051 24"



36601000 6" / 36601011 6" / 13001001 12 5/8"



12453021 4 1/2"



12453011 4 1/2"



12453031 4 1/2"



79545001 2 3/4"

HOBIE "T" SHIRTS

All shirts are 100% cotton with screened graphic designs on the back and chest. (xx = size) sm, md, lg, xl, xxl



5143xx 5144xx 5145xx
Hobie Kayaking - Powered by Hobie MirageDrive



5146xx 5147xx 5148xx
Hobie Fishing - Powered by Hobie MirageDrive



5140xx 5141xx 5142xx
Hobie Oceanside California
5149xx Hobie Jarvis Australia - White
5153xx Hobie Hyères France - White

HOBIE HATS



5016BL
Blue



5018TG
Tan Green



5019BK
6 Panel
Low Pro



5018GM
Gray Mesh



5018BK
Black



5018RM
Red Mesh



5018BL
Blue



5027FF
Fishoflage

HOBIE MICROFIBER HAT
WITH NECK FLAP
5025MF



HOBIE AUSSIE HAT
5024LG (23.6" - 60cm)
5024MD (22.8" - 58cm)



HOBIE BEANIE
5026BW (Women's White)
5026BM (Men's Black)



LID LATCH

Don't let that fancy new hat blow away. Secure it to your shirt or life vest with a Lid Latch. 1553L

HOBIE SPORTSWEAR

Blending the rich heritage and innovation of Hobie with current energy and support of Hurley. See the detailed parts list in the back of the catalog for style numbers including colors and sizes for each item shown here.



HTS070
DIAMOND
WHITE
NAVY

Sizes: S-XXL



HTS0550
SUNSET FISH
HARBOR BLUE
SAND

Sizes: S-XXL



HTS0580
OWNERS MANUAL
WHITE
NAVY

Sizes: S-XXL



HTS020
PHOTO FINISH
TRUE NAVY
OFF-WHITE
SEA GREEN

Sizes: S-XXL



HTS0590
COAST TO COAST
WHITE
HEATHER GREY

Sizes: S-XXL

HTS070 NVY DIAMOND NAVY
WHT DIAMOND WHITE

HTS020 GRN2 PHOTO FINISH SEA GREEN
OFW PHOTO FINISH OFF-WHITE
TNV PHOTO FINISH TRUE NAVY

HTS0550 HAB SUNSET FISH SHRT HARBOR BLUE
HTS0550 SND SUNSET FISH SHRT SAND

HTS0580 10A OWNERS SHRT WHITE
HTS0580 NVY OWNERS SHRT NAVY

HTS0590 10A COAST TO SHRT WHITE
HTS0590 HTG COAST TO SHRT HEATHER GREY



Hobie Mirage Tandem Island
Keauhou Bay, Hawaii
📷 - Jeffrey Fortuna

HOBIE KAYAK SUPPORT / ONLINE SUPPORT - FAQs - FORUMS

For technical help, contact your dealer, see the Hobie website support area or visit our Hobie kayak user forums.

Our on-line support area and forums include FAQs with many technical and user topics.

Hobie Cat Company hobiekatyaks.com / Hobie Australasia hobiecat.com.au / Hobie Kayak Europe hobie-kayak.com

HOBIE KAYAK FAQ

How watertight is my boat? It is normal for any type of kayak to experience a small amount of seepage due to the installation of rivets, hatches, etc. Kayaks may take on a few cups of water while out paddling. If a kayak is taking on more than a small amount of water, check to make sure the drain plug is in, then check the rest of the boat for leaks. Silicone can be used to seal the rivets. If you have any questions, please call your dealer.

How should I store my kayak? It is best to store your kayak upside down or standing on end. If hanging your kayak, do not support from the handles. Best supported by wide webbing straps with the kayak upside down or on its side.

Is my boat repairable? Hobie kayaks are very durable, however, on occasion they may need some minor repairs. Linear polyethylene is repairable. Check with your dealer concerning repairs for your kayak.

Is my boat recyclable? Hobie will recycle your boat when you are done with it. To recycle a Hobie Kayak, it must be cut up so it fits in a box with the following dimensions: may not exceed 130" for the length plus girth, and maximum 108" for the length. Ship the boat to: Hobie Cat 4925 Oceanside Blvd. Oceanside, CA 92056.

HOBIE CAT PARTS - WARRANTY POLICY

HOBIE PARTS WARRANTY Hobie Cat warrants all Hobie Cat manufactured parts and accessories against failure due to materials or workmanship defects for a period of one year.

OUTSIDE USA WARRANTY INFORMATION – Regions Outside of the USA refer to warranty policy statement issued in each country.

OTHER WARRANTY Any accessories and other merchandise sold by Hobie Cat not mentioned in the paragraph above are not warranted by Hobie Cat. Said accessories and other merchandise may be covered by the manufacturer's warranty, a copy of which can be furnished by Hobie Cat upon written request.

HOBIE CAT'S OBLIGATION Hobie Cat at its option will repair or replace without charge any part or accessory which is found to be defective under the terms and within the period of this Warranty. Buyer must return the accessory with a sales slip as proof of purchase date.

BUYER'S OBLIGATION Upon discovery of a suspected defect, Buyer must-at his/her

own expense-promptly return the equipment to the Hobie Kayak dealer for inspection. Warranty is void if equipment is operated after a suspected defect is, or should have been, discovered.

WHO IS ENTITLED TO WARRANTY Only the original Buyer of the equipment and accessories from Hobie Cat is entitled to warranty. Warranty may not be transferred.

NO WARRANTY OF USED EQUIPMENT Used equipment is sold AS IS; Hobie Cat makes NO WARRANTY concerning its merchantability, condition, durability, age or model year, or fitness for any purpose whatsoever.

MUTUAL AGREEMENTS It is agreed that this warranty sets forth Buyer's exclusive right and remedy against Hobie Cat with respect to the equipment and accessories. It is in lieu of all other express warranties and all implied warranties, including implied warranties of merchantability and fitness. Hobie Cat assumes no other like or unlike liability for loss of cargo, use, profit or consequential damages of any kind in connection with the sale, alteration, use, repair or replacement of equipment or any part thereof.

LIVEWELL PARTS

- 72021001 BATTERY
- 72021002 BATTERY CHARGER
- 72021003 SWITCH
- 72021004 INTAKE TUBE ASSY
- 72021005 STRAP SET
- 72021006 BATTERY LID
- 72021007 PUMP CONNECTOR FEMALE
- 72021008 PUMP CONNECTOR MALE
- 72021009 DOWNSPOUT FITTING W/BK RING
- 72021010 INTAKE 90 DEGREE
- 72020015 ROD HOLDER - LIVEWELL
- 72021020 DOWNSPOUT TUBE
- 72021021 TERMINAL COVER
- 72021022 ATTWOOD PUMP
- 72021023 7" INTAKE TUBE (PRO A)
- 72021025 ELEC CONNECTOR REPL SET
- 79050211 DRAIN PLUG

72021025



72021001



72021002



72021003



72021004



72021005



72021006



72021007



72021008



72021009



72021010



72020015



72021020



72021021



72021022

HOBIE MIRAGEDRIVE "GLIDE TECHNOLOGY"

- 80010501 MIRAGE DRIVE GT - ST FINS
- 80013501 MIRAGE DRIVE GTi - ST FINS I SERIES
- 80012501 MIRAGE DRIVE GTT - ST TURBO FINS

TECH TIP!

WHAT MAKES A V2 DRIVE? V2 Drums, V2 Chains, V2 Idler Cable and V2 (Threaded) masts / sprockets (USED IN 2009 production and newer)

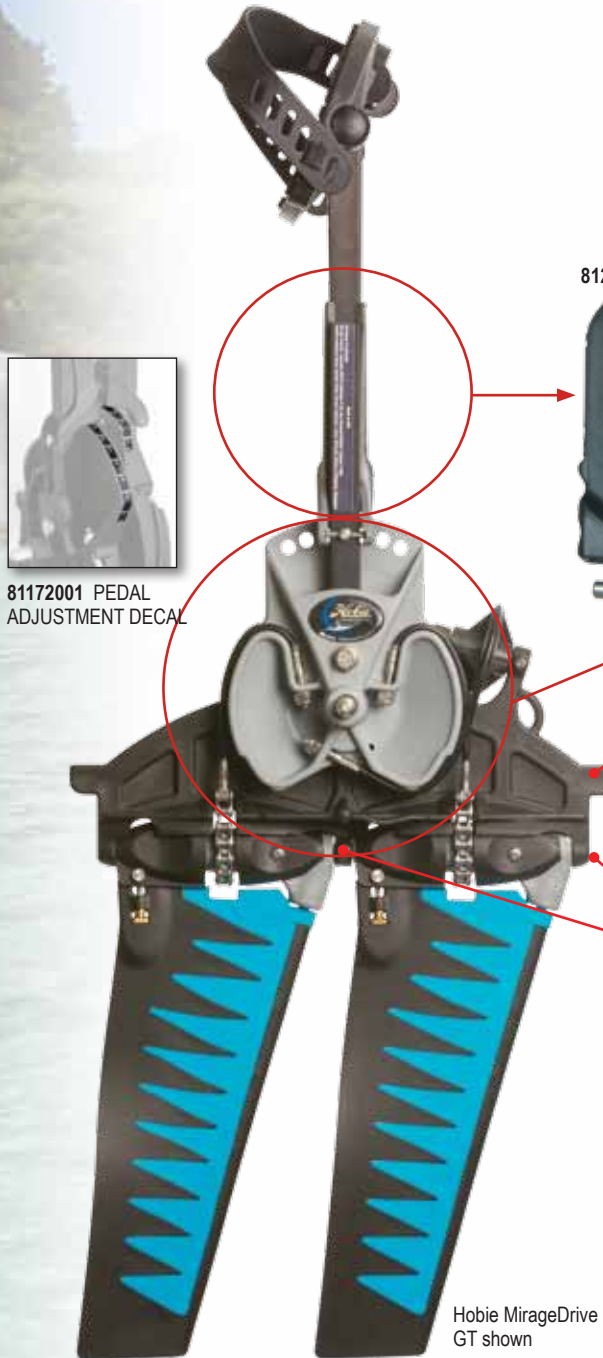

81172001 PEDAL ADJUSTMENT DECAL

Hobie MirageDrive GT shown

81236001 PEDAL ADJ ASSY INCLUDES:

- 81240001 PLASTIC HANDLE
- 81230001 PIN
- 8031201 SCREW
- 81242001 SPRING
- 8034071 ALLEN WRENCH



72020034 PEDAL PAD KIT

- 81222001 PEDAL/CRANK ASSY. (R)
- 81221001 PEDAL/CRANK ASSY. (L)
- 81222011 PEDAL ONLY (R)
- 81221011 PEDAL ONLY (L)
- 81226001 PEDAL STRAP (R)
- 81227001 PEDAL STRAP (L)
- 81222101 CAP - PEDAL
- 8050111 NUT
- 8080541 WASHER

81181001 SPINE NEW 2013

81080001 SPROCKET SHAFT
53170020 SET SCREW

- 81050001 OUTHAUL BLOCK
- 8020041 CLEVIS PIN
- 10860001 LOCK RING

- 81055001 SPROCKET GUARD FWD
- 8031451 SCREW



- 81129001 SPROCKET V2 THREADED (W/ FWD GUARD)
- 81127001 SPROCKET GT THREADED (W/ FWD GUARD)



COMFORT FIN

ST FIN

ST TURBO FIN



81190001

81193001 (GRY/BLK)

81193021 (RED/BLK)

81193031 (BLU/BLK)

81192001 (GRY/BLK)

81192021 (RED/BLK)

81192031 (BLU/BLK)

- 81163001 MAST V2 THREADED
- 81198101 MAST / ST TURBO V2 THREADED
- 8000341 LOC-TITE .5ML

UPDATE KIT - V2 SPROCKET
(2 V2 SPROCKETS AND 2 V2 MASTS)
81129022 V2 STANDARD MAST KIT
81129122 V2 TURBO MAST KIT

UPDATE KIT - GT SPROCKET
(2 GT SPROCKETS AND 2 V2 MASTS)
81129023 GT STANDARD MAST KIT
81129123 GTT TURBO MAST KIT



HOBIE MIRAGEDRIVE "V2" / "GT"

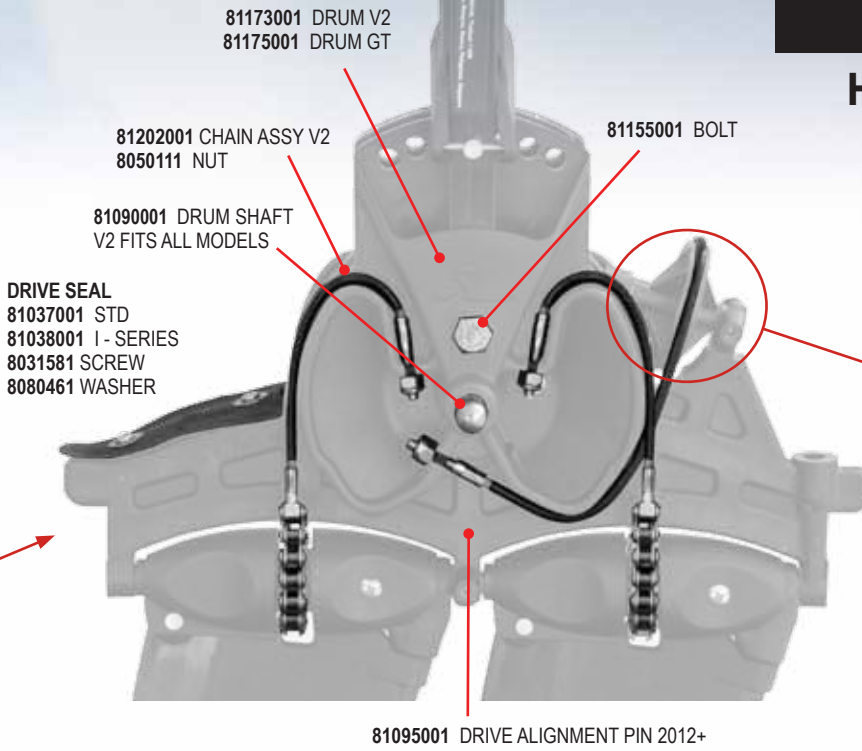

81121001 IDLER PULLEY
81123001 IDLER PULLEY GT

81203001 IDLER CABLE V2 (18.5")
8050111 NUT

53170020 SET SCREW



HOBIE MIRAGEDRIVE "V1"

Drive with older plastic drum, plastic spine, Sprocket / mast connection is a set-screw

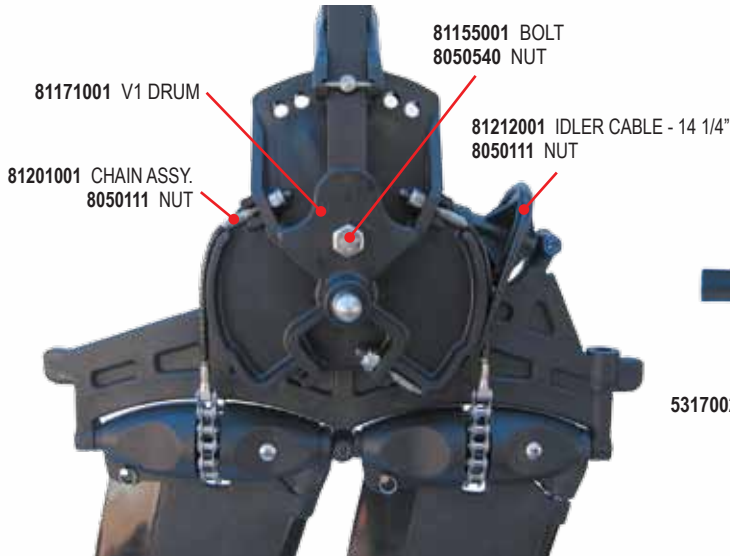

TECH TIP!

MAINTENANCE AND TUNING - Maintenance and tuning information for MirageDrives is available on the Hobie Cat website support area. <http://www.hobiecat.com/support/history/>

Direct link to the support pages for kayaks is here: <http://www.hobiecat.com/support/products/kayaks/>



UPDATE KIT - V2 SPROCKET
(2 V2 SPROCKETS AND 2 V2 MASTS)
81129022 V2 STANDARD MAST KIT
81129122 V2 TURBO MAST KIT

V1 Sprocket / mast connection uses a set-screw

MIRAGEDRIVE SPARE PARTS KITS

Spare parts kits include a spare fin, mast, sprocket, chain, clevis pin and ring. All in a handy zippered pouch. Available for the standard fin drives or drives with ST Turbo fins. Standard kit shown.



MIRAGEDRIVE V2 (THREADED MAST STYLE)

Includes parts listed above for V2 "threaded mast" drives.

80010301 KIT V2 STANDARD FIN
80013301 KIT V2 TURBO FIN

MIRAGEDRIVE OLDER V1 (SET SCREW MAST STYLE)

Includes parts listed above plus: Set screw, allen wrench, and a cotter key.

80010201 KIT STANDARD FINS
80013201 KIT TURBO FINS

HOBIE MIRAGEDRIVE— OLDER —

Original drive with aluminum spine, stainless sprocket / mast connection is cotter key.

81130001 SPROCKET (STAINLESS)
81340001 SPROCKET BUSHING (SS SPKT)
81420001 SPROCKET GUARD
8060111 COTTER KEY (MAST / SS SPKT)
81040001 OUTHAUL BLOCK (SS SPKT)
8020061 CLEVIS PIN
10860001 LOCK RING
81211001 IDLER CABLE 14 3/4" (SOLID PULLEY)
81150001 DRUM BUSHING (ALUM DRUM)
81105001 CRANK ARM RIGHT, THREADED
81100001 CRANK ARM LEFT, THREADED

 **71301001** HATCH SEAL "TRIM-LOC"
(TOP MOLDED) 5' REQ

 **71302001** HULL FLANGE SEAL (PRE 2012 ADV)
"TRIM-LOC" (SIDE GLUED) 5' REQ

71220001 METAL PAD EYE
8030071 SCREW

76050001 BOW/ STERN HANDLE

72542001 DOME STICKER 1.75"

74075001 PADDLE 2-PEICE FIBER SHAFT
(Only sold as matched set)

74010001 REPLACEMENT BLADE RIGHT
74011001 REPLACEMENT BLADE LEFT

74030002 DRIP RING FG SHAFT
74030001 DRIP RING ALUM SHAFT

230cm

74076101 BUTTON PLASTIC
74076102 BUTTON SS

74049001 PADDLE "T" HANDLE



72104001 HOOK

80012001 PEDAL RETAINER BUNGEE w/ HOOK

78560001 MESH STOWAGE POCKET
8031501 SCREW
78561001 HOOKLESS STOWAGE POCKET

84560001 MAST RECEIVER COVER
8031151 SCREW

84550001 MAST RECEIVER

SEE MIRAGEDRIVE PAGE
FOR DRIVE DETAILS

38120031 PUSH-IN CAP (White)
(Underside Of Hull)

10730000 CLEAT
8030111 SCREW

72103001 SHOCKCORD END
8031130 SCREW

81535001 MIRAGE CASSETTE PLUG

WATER BOTTLE GUIDE

71999011 SMALL BOTTLE 16 Oz.
(Sport/Outback/Quest/Kona/Pro A)

71997001 MEDIUM BOTTLE 20 Oz.
(Odyssey/Lanai/Maui/Quest 13 (2013+))

71998001 LARGE BOTTLE 32 Oz.
(Revolution/Adventure/Adventure Island/
Outfitter/Oasis)

KET



8031570 SCREW / PADDLE KEEPER BUNGEE
79538201 WEB PULL TAB



81611101 CLICK AND GO ASSY (L)
81611201 CLICK AND GO ASSY (R)

8030791 SCREW
(REQUIRES 3/16" allen "BALL-END" wrench)

81602101 SPRING CLICK AND GO LEFT
81602201 SPRING CLICK AND GO RIGHT



2008 AND OLDER
81410001 CAM LOCK KNOB
BOLTS VARY BY MODEL

RUDDER - UP / DOWN

8004531 LINE (BLK)
81450001 HOBIE CHEEK BLOCK
8031065 10-32 X 7/8 SCREW
8031069 10-32 X 1-1/4 SCREW (AI)
8050211 NUT



81408101 HANDLE
81406101 INSERT - UP
81407101 INSERT - DOWN



81408001 OLDER HANDLE
81406001 OLDER DECAL - UP
81407001 OLDER DECAL - DOWN



10730021 CLEAT STBD
10730031 CLEAT PORT
8031541 SCREW

OLDER UP / DOWN



81392001 TWIST AND STOW CONTROL ARM UP/DOWN
81380001 OLDER - CONTROL ARM UP/DOWN
81375001 SPRING
8080691 NYLON WASHER
81035011 BOLTED HANDLE AND CONTROL ARM KIT



81035001 UP / DOWN HANDLE
w/ SET-SCREW

RUDDER - STEERING

STEERING CRANKS

81014001 SPORT/REV 11
81016001 REV 13 / OB
81017001 OUTFIT / OASIS
88991281 CRANK - AI 2011+/TI



STEERING

81013001 STEERING HANDLE
8030126 SCREW
88991152 STICKER
81385001 WASHER
88991235 PIN
H071 SPRING



88991355 KNOB ASSY
(Handle Not Included)

OLDER STEERING



81015001 STEERING HANDLE
w/ SET-SCREW



81370001 CRANK
81372001 CRANK AI-OUTFIT
H071 SPRING
8080691 NYLON WASHER

MIRAGE SERIES SEAT

- 81269001 MIRAGE BACKREST - TWIST LOCK
- 81268001 MIRAGE BACKREST - EXPAND PEG
- 81259001 SEAT STRAP w/ HOOK



- 81277001 HANDLE
- 81245001 ROLL PIN
- 81276001 TWIST-LOC

81276201 TWIST-LOC SEAT KIT (PAIR)
(Fit Older Seat Into Twist Loc Hull)

81275001 TWIST-LOC RECEIVER* (IN HULL)
* REPLACEMENT PART ONLY - NOT RECOMMENDED AS AN UPGRADE



- 71190001 WEBBING LIFT HANDLE (PLASTIC END)
- 71190000 WEBBING LIFT HANDLE (WEB WITH HOLE)
- 8032011 SCREW
- 8080571 WASHER



- 76055001 MIDSHIP HANDLE
- 8032011 SCREW



- 88991061 MIDSHIP HANDLE
- 8032011 SCREW



OLDER SEAT PEGS



- 81265101 SEATBACK ADJUSTABLE PLUG KIT (PR)



- 81265001 SEATBACK PLUG
- 8031130 SCREW
- 8080541 WASHER

PADDLE SERIES SEAT



- 72402001 SEATBACK / PADDLE MODELS 2010
- 72409001 SEAT STRAP W/HOOK



- 10092030 PLUG
(Seat area of Adventure, Kona, Outfitter, Revolution)



- 72009001 SCUPPER PLUG
(Pursuit/ Maui/ Lanai)



- 72010 SCUPPER PLUG (Odyssey)



41220001 EYELET POST
8031131 SCREW



53180011 3/8" HOG RING
21180000 1/2" HOG RING



78520001 EYELET HOLD DOWN
8032121 SCREW



RS316BLK 3/16" SHOCKCORD
RS014BLK 1/4" SHOCKCORD
79538201 WEB PULL TAB



71110001 PADEYE
8030031 SCREW
8012001 RIVET



71120001 LASHING HOOK
8030031 SCREW



78510001 BUNGEE HOOK
8031961 SCREW



2101 SHOCKCORD FASTENER, 1/4"



71230001 ROD HOLDER COVER
8031131 SCREW

HATCHES



71130001 HATCH 5" SCREW-IN
8031501 SCREW



71701011 HATCH 6" TWIST AND SEAL
71701001 HATCH 6" TWIST AND SEAL RETRO KIT
71321001 FLANGE GASKET / 71701021 LID O-RING
8031131 SCREW



71702011 HATCH 8" TWIST AND SEAL
71702001 HATCH 8" TWIST AND SEAL RETRO KIT
71331001 FLANGE GASKET / 71702021 LID O-RING
8031131 SCREW

TECH TIP!

DECK FASTENERS - Customize your boat with the fasteners of your choice... where you want them. The Hobie screw-in fittings can be easily removed and replaced. Add an extra eye where we placed a hook, a cleat hook where a shockcord end is placed... You choose what works best for you. Use tool #71115101

SCREW-IN FITTINGS



71116001 PADEYE



71117001 CLEAT



71115001 SHOCKCORD END



71115101 TOOL SCREW IN FITTINGS



72012001 SCUPPER PLUG
(Quest / Kona / Outback)

TECH TIP!

MAINTENANCE AND TUNING - Maintenance and tuning information for Twist and Stow rudder systems is available on the Hobie Cat website support area.
<http://www.hobiecat.com/support/history/>

Direct link to the support pages for kayaks is here:
<http://www.hobiecat.com/support/products/kayaks/>



10091000 DRAIN PLUG W/ O-RING
 10092025 O-RING

79050211 DRAIN PLUG W/ O-RING
 79050212 O-RING

81394001 RUDDER PIN

81394021 RUDDER PIN 2011 CENTERLINE
 STYLE REQUIRES MODIFIED HOUSING

81391011 GUDGEON
 8030214 SCREW (2)

71280001 KEEL GUARD LANAI, KONA, QUEST, ODYSSEY
 8030231 SCREW (2)

LINE AND TUBE ASSEMBLY
 80025001 (1)
 80020001 UNIVERSAL LINE
 REPLACEMENT KIT
 (SET OF 4 AND ADDITIONAL LINE)



81023001 SPECTRA CONTROL LINE
 8063001 SWEDGE
 81400001 TUBING
 81405001 TUBE HOLDER
 81405101 END CAP

TWIST AND STOW RUDDER

8080791 WASHER

8030641 SCREW

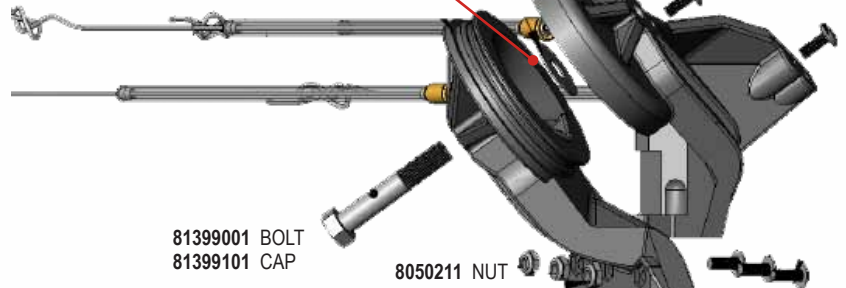

81399001 BOLT
 81399101 CAP

8050211 NUT

TWIST AND STOW
 RUDDER ASSEMBLY
 81395001 SM BLADE
 81396001 LG BLADE

8030281 SCREW

EARLY RUDDER PARTS

NYLON RUDDER PIN

81361001 CLASSIC
 81362001 OLDER OUTBACK
 81362001 OLDER SPORT
 81362001 OLDER TANDEM
 20860000 LOCK RING

81360001 S.S. RUDDER PIN

8030171 SCREW
 8080541 WASHER

81350001
 RUDDER MOUNT

81390001 RUDDER BLADE

RUDDER BLADE
 81395201 SM
 81397001 LG

QUEST

QUEST TWIST AND STOW RUDDER KIT

- 78501 QUEST 13
- 78502 QUEST 11



37380001 CLAM CLEAT



- 61070000 CLEAT
- 8031131 SCREW

8" HATCH

- 78540001 TRACK / FOOT BRACE
- 78535001 FOOT BRACE / LEFT
- 78536001 FOOT BRACE / RIGHT

MIRAGE CLASSIC



- MIRAGE CLASSIC & PURSUIT
- 71201 CARGO COVER
- 71301001 LOC SEAL, 6.5FT

91281000 DRAIN SCREW

HOBIE MIRAGE i - SERIES

- 79050214 SCUPPER PLUG
- 79052007 SEATBACK / i-SERIES

- 79050061 i-SERIES CASSETTE PLUG
- 79050021 CLICK and GO SPRING

- 71702011 HATCH 8" TWIST AND SEAL
- 71331001 FLANGE GASKET
- 71702021 LID O-RING
- 8031130 SCREW

79052017 VALVE ASSY



- 81394001 RUDDER PIN
- 81395201 SMALL RUDDER BLADE
- 81395001 RUDDER ASSY. W/ SM. BLADE

76050001 BOW / STERN HANDLE

79050211 DRAIN PLUG W/ O-RING

79052019 PADDLE HOLDER

74077001 PADDLE 4 PC ALUMINUM SHAFT

80012001 PEDAL RETAINER BUNGEE w/ HOOK



79052000 i – ACCESSORY HOLDER KIT
Designed to allow the attachment of rod holders and other accessories to the Hobie Mirage inflatable kayaks. The accessory kit comes with 2 mount plates and attachment glue. 4 hole pattern fits Scotty mount and RAM / Scotty hole pattern products. Mount the 80052001 Scotty Deck/Side mount and Scotty rod holders or adapt for the RAM products by adding RAM Wedge Mounts 72023015 or 72023016. (1/4-20 Screws sold separately, check length for desired accessory / #8030380 7/8" length for Scotty deck mount).

79052006 i – HARDWARE ACCESSORY KIT
Includes padeyes, spare cleats and glue. Customize your Hobie inflatable.

79052001 i – CUP HOLDER KIT
Includes 2 flexible can / cup holders and glue. Customize your Hobie inflatable.

80045101 i - KAYAK CART "PLUG-IN"

79052015 i – TRI RING KIT / SAGE

79052016 i – TRI RING KIT / SUNDANCE

Includes 2 "Tri" rings mounted on round patches ready for installation. Customize.

79052009 i – HULL REPAIR KIT
Includes 2 colors of repair vinyl and glue, valve tool and instructions. Repair or customize a Hobie Mirage Inflatable kayak.

79052005 i – ELECTRIC INFLATION PUMP
Electric pump connects to car 12v outlet. Quickly and easily fill your Hobie inflatable. This is a high volume / low pressure pump. Use the standard pump to bring chambers to full pressure.

79052003 i – STANDARD INFLATION PUMP
Standard hand pump for Hobie inflatable.

- 79052010 i – 12 TRAVEL BAG
- 79052011 i – 14 TRAVEL BAG
- 79052012 i – 9 TRAVEL BAG

V1 SHOWN / 2011 MODEL YEAR + = V2)



The Hobie Island Club is a place to meet other Hobie Mirage® Adventure Island and Hobie Mirage Tandem Island owners to share passions for the waterways and oceans of our world. Hobie Dealers are organizing local Island Clubs worldwide. The Hobie Island Club will assist in the introduction of Island owners to one another where dreams of sailing to places unknown and countless adventures can become a reality. hobiecat.com/hobie-island-club



*RUDDER UPDATED SPRING 2011
CURRENT RUDDER SHOWN ON TANDEM ISLAND PAGE

OLDER MODELS

81396001 TWIST AND STOW RUDDER ASSY / LG BLADE
81397001 LARGE SAILING RUDDER BLADE
SEE RUDDER PAGE FOR
TWIST AND STOW DETAILS

71115001 END FITTING
RS014BLK SHOCK CORD (1')

71190001 LIFT HANDLE
8032011 SCREW
8080571 WASHER

79520301 AKA END CAP

79545001 AMA "HOBIE" DOME LOGO

79520201 AKA COLLAR
8010181 RIVET

99303001 AMA PAPAYA
99304001 AMA HIBISCUS
99304101 AMA NEW RED
99305001 AMA DUNE

41220001 EYELET POST
8031130 SCREW

79526211 PADDLE WEBBING

79531001 XBAR
8030781 SOC

79521001 AKA V1 (L) REAR
79512401 AKA V2 (L) REAR

79512601 XBAR
79510721 XBAR
79510731 XBAR
8032088 SCR
8080561 WAS

79538101 PADDLE HOLDER KIT
79538001 PADDLE RETAINER CLIP

79535001 AKA (V1) CONNECTOR PIN
RS316BLK 3/16" SHOCK CORD (9")
53180011 HOG RING

38670011 "S" HOOK

H082 BULLET BLOCK

H083 BULLET BLOCK w/BECKET

RMO14BLK MAINSHEET (32')

79530001 XBAR V1 REAR
8030781 SOC CAP SCREW

79512701 XBAR V2 REAR
79510721 XBAR CLAMP TOP
79510731 XBAR CLAMP BOTTOM
8032088 SCREW
8080561 WASHER

79525001 BALL / BRACE
8030212 SCREW

79522001 AKA V1 (R) REAR
79512501 AKA V2 (R) REAR

79523101 AKA BRACE ASSY V1 (L)
79523102 AKA BRACE ASSY V1 (R)

79537001 BRACE RETAINER CLIP

79523201 AKA BRACE ASSY - V2 (L)
79523202 AKA BRACE ASSY - V2 (R)

79050211 DRAIN PLUG W/ O-RING
79050212 O-RING

79524001 CAP / AKA BRACE LOCK
79523001 SOCKET / AKA BRACE LOCK
81242001 SPRING / AKA BRACE LOCK
8030781 SOC CAP SCREW

8032081 SHEAR BOLT
8052081 NUT
88991221 BRACE CONNECTOR
8020381 CLEVIS PIN
20860000 SPLIT RING
37661091 LANYARD

10091000 DRAIN PLUG W/ O-RING
10092025 O-RING



71116001 EYE



79510201 MAST / SAIL BAG

- 79520001 AKA FWD (L/R)
- 79512301 AKA V2 (L) FWD

V2 UPDATES

- 81412001 AKA CASTING GLUE KIT

R V1 FWD
CAP SCREW

R AI V2 FWD
R CLAMP TOP
R CLAMP BOTTOM
EW
SHER

8004381 (12) FURLING LINE

- H233 CHEEK BLOCK
- 8030151 SCREW
- 8080500 WASHER
- 8050211 NYLOCK NUT
- H424B FAIRLEAD
- H471 CLEAT



- 81391002 RUDDER
UP/DOWN "T" HANDLE LINE KIT
UPGRADE FOR EARLY BOATS

- 8031481 SCREW
- 79531101 CLEAT WEDGE WITH FAIRLEAD
- 79531111 MAIN CLEAT WEDGE

- 79520001 AKA V1 (L/R) FWD
- 79512201 AKA V2 (R) FWD



79502001 DAGGER BOARD



79501001 FOAM PLUG /
DAGGER WELL



79526001 AKA CARRY BAG

- 88991311 MAST CAP
- 79511021 MAST OLDER SWIVEL TIP

- 79510001 '07 MAST ISLAND (2 PC)
- 79510011 '08 MAST ISLAND (2 PC)



'07 BASE



COLLAR KIT

- 79511001 MAST BASE / '07 PIN TYPE
- 79510101 MAST BASE COLLAR KIT

- 79511101 '08 MAST BASE / HOLE TYPE

- 79509001 SAIL GRAY/WHT
- 79516001 SAIL PAPAYA/TURQ/WHT - BREEZE
- 79515001 SAIL RED/GRAY/WHT - SMOKE
- 79546001 SAIL ADV WHT/GRAY/TURQ - AZUL

- 91051011 BATTEN 9' 2"
- 91041011 BATTEN 7' 8.5"



- 91011001 BATTEN LEECH CAP
- RH112WHT BATTEN TIE LINE (REQ 18" PER)

- 22080011 BATTEN LUFF CAP SET

- 79512001 FURLER DRUM AI



- 79533001 MAST BEARING PLATE (REQ 2)
- 8031231 SCREW
- 8050801 NUT
- 90610111 BEARINGS (EA / REQ 24)

- 79532001 V1 MAST RETAINER SPRING

- 79514101 '08+ MAST RECEIVER
- 8030261 MOUNTING SCREW
- 8080211 WASHER
- 71320001 GASKET
- 79513001 BACKUP RING
- 79551001 LEVER / LATCH
- 8031151 SCREW
- 79555001 SPRING



- 8032011 MAST STEP PLATE SCREW

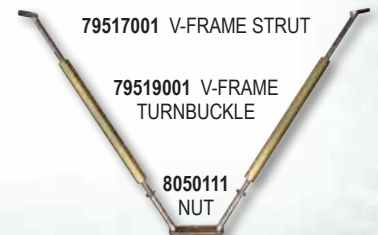

79517001 V-FRAME STRUT

79519001 V-FRAME
TURNBUCKLE

8050111
NUT

- 79518001 V-FRAME BASE

- 88991215 SET SCREW

RUDDER PARTS



88991094 GUDGEON (3 HOLE)

CURRENT

8030214 1/4-20 SCREW (2)

8030355 5/16-24 SCREW (1) LOWER

OLDER (2 HOLE GUDGEON)

8030214 1/4-20 SCREW (1) (OR 2")

8030346 1/4-20 STUD-NUT HEAD PH17-4 (1) LOWER

*OLDEST, LOWER LATER REPLACED BY
8030346 STUD (STRONGER FOR 2 HOLE)

88991101 RUDDER PIN

88991092 RUDDER HOUSING

88991093 PULLEY

88991091 BLADE

88991099 RUDDER UP STRAP ASSY

82420001 RUDDER COVER AI / TI

88991303 AMA PAPAYA

88991304 AMA HIBISCUS

88991314 AMA NEW RED

88991305 AMA DUNE

79520311 AKA FWD (L/R)

88991061 HULL LIFT HANDLE

8032011 SCREW

88991301 STEERING HANDLE

88991235 ROLL PIN

8030125 SCREW

88991151 STICKER

88991355 (2011) STEER KNOB ASSY

79531201 XBAR FWD ASS

88991271 SPACER BLOC

8030451 SCREW (CUP A

8050111 NUT (CUP ATTA

79520401 AKA LEFT REAR

88523101 AKA BRACE ASSY (L)

79530201 XBAR REAR ASSY

MAINSHEET SYSTEM

38670011 "S" HOOK

H083 BLOCK-BULLET w/ BECKET

RM014BLK LINE (55')

H2655 BLOCK, 40MM CARBO FIDDLE

H2131 SHACKLE W/PIN 5/32"

88991001 CENTERBOARD

88991021 PIN

88991031 PIN HOLDER

8031461 SCREW

8030671 SCREW

88991011 COVER

8030071 SCREW (4)

81242001 SPRING

88991041 KNOB

88991150 CAP

88523102 AKA BRACE ASSY (R)

79520501 AKA RIGHT REAR

RUDDER REPLACEMENT SPRING 2011 (88991098)
CONTACT DEALER FOR REPLACEMENT RUDDER
DETAILS IF YOU ARE USING TWIST AND STOW SYSTEM

81051001 1,000 LB UP CONTROL LINE



79510202 MAST / SAIL BAG

- 79520601 AKA SPRING HOOK
- 79522201 AKA LOCK BEARING
- 8031401 SCREW



- 79510721 XBAR CLAMP TOP
- 79510731 XBAR CLAMP BOTTOM
- 8032088 SCREW
- 8080561 WASHER

79520311 AKA FWD (L/R)



- 88991311 MAST TIP
- 88991121 MAST TANDEM ISLAND (2 PC)
- 88998514 SAIL DUNE
- 88998515 SAIL SMOKE
- 88998516 SAIL BREEZE
- 88998521 BATTEN #1 (3/8" 186" w/ CAP)
- 88999519 BATTEN CAP 3/8"
- 88998522 BATTEN #2 (3/16" 42 1/2" w/ CAP)
- 88998523 BATTEN #3 (3/16" 39 1/2" w/ CAP)
- 91011001 BATTEN CAP 3/16"



BATTEN LEECH CAP

- RH112WHT BATTEN TIE LINE (REQ 18" PER)
- 22080011 BATTEN LUFF PROTECTOR CAP SET
- 88991071 FURLER DRUM TI



- 79533001 MAST BEARING PLATE (REQ 2)
- 8031231 SCREW
- 8050801 NUT
- 90610111 BEARINGS (EA / REQ 24)

8004381 (12') FURLING LINE

79511101 MAST BASE

- 79514101 MAST RECEIVER
- 8030261 MOUNTING SCREW
- 8080211 WASHER



- 71320001 GASKET
- 79513001 BACKUP RING
- 8032011 MAST STEP PLATE SCREW



88991191 V-FRAME STRUT



88991211 V-FRAME TURNBUCKLE

8050111 NUT

88991201 V-FRAME BASE

88991215 SET SCREW

PRO ANGLER 14 (SEE 2013 FOR CHANGES)

ROD HOLDER STORAGE

- 84500911 3 ROD HOLDER ASSY LEFT
- 84500921 3 ROD HOLDER ASSY RIGHT

- 84502001 MOUNTING BOARD, RT
- 84502101 MOUNTING BOARD, LT
- 8030341 SCREW
- 8032085 SCREW
- 8050111 NUT

- 84502401 FLOOR MAT RT
- 84502501 FLOOR MAT LT-BLK

STEERING (PRO A) REVERSIBLE ASSY KIT INCLUDES ALL PARTS TO REPLICATE 2011 STEERING ON OLDER MODELS. MOUNT ON PORT OR STARBOARD SIDES
84506201



- 84500601 COVER PLT, RDR SYSTEM
- 8030151 SCREW (4)
- 84500801 TUBE RESTRICTOR (2)

- 84500501 STEERING DRUM (PIN TYPE OLDER)
- 8060141 COTTER KEY (REPL ROLL PIN)

- 84500502 STEERING DRUM (SCREW TYPE)
- 8030126 SCREW
- 88991235 PIN

- 84500401 RDR MOUNT, UNDER HULL (PIN TYPE OLDER)
- 84500402 RDR MOUNT, UNDER HULL (SCREW TYPE)

- 84500201 RUDDER HOUSING, UNDER HULL

- 84502301 SISTER SCREW, PRO RDR ASSY
- 8031490 SCREW SCREW 8-32 X 1/2 FHMS-P

- 84504001 TORSION SPRING, RUDDER

- 84500101 RUDDER BLADE, PRO A
- 84612001 RUDDER BLADE, LARGE PRO A

- 84504501 HANDLE - BOW
- 8030361 SCREW SOC CAP
- 79545001 "HOBIE" DOME LOGO



- 71305001 HATCH SEAL LARGE BULB (7.25')



- 84501901 HATCH LINER FWD - PRO ANGLER

- 72020311 PLANO BOX - SMALL YELLOW
- 72020321 PLANO BOX - MEDIUM BLUE
- 72020331 PLANO BOX - LARGE RED



- 84505001 STORAGE BUCKET ASSY (INCLUDES COMPARTMENT WITH DIVIDERS)
- 84505101 STORAGE BUCKET COMPARTMENT
- 84505201 REPLACEMENT COMPARTMENT DIVIDERS (SET OF 7)
- 71301001 TRIM LOC TOP MOLDED 3.5'

- 8004531 CONTROL LINE (9')
- 81408101 HANDLE
- 81406101 INSERT - UP

- 84502201 CUTTING BRD, CNTR, BLACK
- 8030071 SCREW
- 8050111 NUT
- 84502211 BUNGEE AND FITTING ASSY

- 84500001 SEAT ASSEMBLY - PRO ANGLER
- 84500011 LUMBAR SUPPORT PAD
- 84502901 KNOB, SEAT FRAME FRONT
- 8031811 STUD (FWD)
- 8042151 BOLT SHOULDER (REAR)
- 84500021 SEAT STRAP ASSY (ONE SIDE)
- 8011231 RIVET
- 84500031 STAINLESS REPLACEMENT BUCKLE

- 84504101 UNIVERSAL SIDE HANDLE ASSY
- 84504401 HANDLE END FITTING
- 8031781 SCREW SOC CAP
- 84504301 DECAL, RULER

- 71996001 BOTTLE/CAN HOLDER
- 74035001 FOLDING PADDLE CLIP

- 71702011 HATCH 8" TWIST AND SEAL

- 84504201 TUBE, STERN HANDLE
- 84504401 HANDLE END FITTING
- 8031781 SCREW SOC CAP

- 72013001 SKID GUARD, PRO
- 8030641 SCREW
- 10091000 DRAIN PLUG

PRO ANGLER 12 / PRO ANGLER 14 (2013)



84501211 2 ROD HOLDER ASSY PA12 LT
84501221 2 ROD HOLDER ASSY PA12 RT

84502001 MOUNTING BOARD RT
84502101 MOUNTING BOARD LT
8030341 MOUNTING BOARD SCREWS

86506601 FLOOR MAT PA12 LT
86506701 FLOOR MAT PA12 RT

88991301 STEERING HANDLE
86505401 SECONDARY STEERING HANDLE
88991235 ROLL PIN
8030125 SCREW
88991151 STICKER
86505001 STEERING CRANK
86505101 STEERING CRANK SUPPORT
8031065 SCREWS
8050211 NUTS
81244001 STEERING SPRING
86505121 DUAL STEERING LINE ASSEMBLY

84507601 CHAIR FOOT MOUNT
8032231 CHAIR FOOT MOUNT SCREWS

84508001 VANTAGE KICKSTAND ASSEMBLY
8032241 KICKSTAND MOUNTING SCREW
84500821 KICKSTAND WEBBING ASSEMBLY
8030151 WEBBING SCREWS

86505601 LOWRANCE READY COVER PLATE
8030671 COVER PLATE SCREWS
86506001 LOWRANCE ADAPTER
86506101 LOWRANCE STAR MOUNT ADAPTER
84505901 HUMMINBIRD ADAP KIT
86506201 TRANSDUCER SUPPORT CLIP
86509501 SCREW
8050211 NUT

86505611 THRU HULL PLUG
(INCLUDES PLUG, NUT AND O-RING)
86505701 RUBBER ADAPTER PLUGS

86505621 THRU HULL WIRING KIT
(INCLUDES 2 PLUG, ADAP TREE)



84504501 HANDLE BOW
8030361 SCREW SOC CAP

79545001 "HOBIE" DOME LOGO

84507771 ANCHOR TROLLEY INSERT CAPS

41220001 EYELET POST
8010131 RIVET

84501201 HATCH LINER, PA12

72020321 PLANO BOX - MEDIUM BLUE
72020331 PLANO BOX- LARGE RED
71305001 HATCH SEAL LARGE BULB
PA12 - 5.16' / PA14 - 7.25'

71707001 RECTANGULAR HATCH TWIST AND SEAL
71707002 FLANGE GASKET
8032121 SCREWS (14)
71708001 TACKLE MANAGEMENT RACK
8004531 TACKLE MANAGEMENT LINE (14" CL)



71709001 BUCKET, HOBIE RECTANG HATCH



81408101 HANDLE
81401101 CAP, RUDDER
81401001 CAP, SEAT
8004531 CONTROL LINE (9')

84507721 UNDER SEAT PAD
84501231 UNDER SEAT TACKLE BOX WEBBING ASSEMBLY
8030151 SCREWS

84504601 PA12 SIDE CARRY HANDLE
84504901 DECAL RULER PA12
71996001 BOTTLE/ CAN HOLDER

71119001 PADDLE CLIP PA12



71702011 HATCH 8" TWIST AND SEAL

72013001 SKID GUARD, PRO
8030641 SCREW
10091000 DRAIN PLUG

84504801 TUBE STERN HANDLE, BLUE GREY
84504401 HANDLE END FITTING
8031781 SCREW SOC CAP

VANTAGE ST (PA12 & 14)



VANTAGE XT (PA17)

For Vantage XT support issues, parts diagrams, videos on function, see hobiecat.com/support



VANTAGE CT (2015 MIRAGE MODELS)

For Vantage CT support issues, parts diagrams, videos on function, see hobiecat.com/support



INDEX

Part	Description	OS		
86505121	DUAL STEERING LINE ASSEMBLY	-	3859MD	SHIRT,LADIES SPORT-T SS VN MD
86505401	SECONDARY STEERING HANDLE	-	3859SM	SHIRT,LADIES SPORT-T SS VN SM
86505601	LOWRANCE READY COVER PLATE	-	3859XL	SHIRT,LADIES SPORT-T SS VN XL
86505611	THRU HULL PLUG	-	5016BL	VISOR HOBBIE BLUE
86505621	HOBBIE THRU HULL WIRING KIT	-	5018BK	HAT HOBBIE "H" BLACK
86505701	RUBBER ADAPTER PLUGS (TREE)	-	5018BL	HAT HOBBIE "H" BLUE / GOLD
86506001	LOWRANCE ADAPTER	-	5018GM	HAT HOBBIE "H" GRAY MESH
86506101	LOWRANCE STAR MOUNT ADAPTER	-	5018RM	HAT HOBBIE "H" RED MESH
86506201	TRANSDUCER SUPPORT CLIP	-	5018TG	HAT HOBBIE "H" TAN w/ GREEN LOG
86506601	FLOOR MAT PA12 LT	-	5019BK	HAT "HOBBIE" 6-PANEL LO PRO BLK
86506701	FLOOR MAT PA12 RT	-	5024LG	HAT, AUSSIE LG (60cm/23.6") KH
86509501	SCREW 10-32 X 1-3/4 PHMS SS	-	5024MD	HAT, AUSSIE MD (58cm/22.8") KH
87363222	FLOOR STAND, MIRAGE RIGGING	-	5025MF	HAT, MICROFIBER w/NECK FLAP KH
87369116	BOOK, HOBBIE-MASTER OF WATER,	-	5026BM	HAT, BEANIE MEN'S BLK w/ RED L
88523101	BRACE ASSY (L) AKA TI -22"	-	5026BW	HAT, BEANIE WOMEN'S WHT w/LT B
88523102	BRACE ASSY (R) AKA TI -22"	-	5027FF	HAT- FISHOUFLAGE
88527001	TRAMP SET TI - BLACK	-	5027OM	HAT- ODM
88527011	TRAMP SET TI - GRAY	-	5140SM	T-SHIRT OSIDE BLK SM
88991001	CENTERBOARD TDM ISLAND	-	5140XL	T-SHIRT OSIDE BLK XL
88991011	CENTERBOARD TOP CVR-TDM ISLAND	-	5140XXL	T-SHIRT OSIDE BLK XXL
88991021	CENTERBOARD PIN-TDM ISLAND	-	5141LG	T-SHIRT OSIDE WHT LG
88991031	PIN HOLDER-TDM ISLAND	-	5141MD	T-SHIRT OSIDE WHT MD
88991041	KNOB-TDM ISLAND	-	5141SM	T-SHIRT OSIDE WHT SM
88991061	SIDE CARRY HANDLE-TDM ISLAND	-	5141XL	T-SHIRT OSIDE WHT XL
88991071	FURLER DRUM - TDM ISLAND	-	5141XXL	T-SHIRT OSIDE WHT XXL
88991091	RUDDER BLADE, ISLAND	-	5142LG	T-SHIRT OSIDE CYAN LG
88991092	RUDDER HOUSING, ISLAND	-	5142MD	T-SHIRT OSIDE CYAN MD
88991094	GUDGEON, A/ITI	-	5142SM	T-SHIRT OSIDE CYAN SM
88991098	RUDDER REPLACEMENT KIT T/IAI	-	5142XL	T-SHIRT OSIDE CYAN XL
88991099	RUDDER-UP STRAP ASSY	-	5142XXL	T-SHIRT OSIDE CYAN XXL
88991101	RUDDER PIN-TDM ISL / 2011+ AI	-	5143LG	T-SHIRT KAYAK BLK LG
88991121	MAST-TDM ISLAND ASSY (550 CM)	OS	5143MD	T-SHIRT KAYAK BLK MD
88991150	KNOB CAP-TDM ISLAND	-	5143SM	T-SHIRT KAYAK BLK SM
88991151	DOVE DECAL LG HANDLE, H LOGO	-	5143XL	T-SHIRT KAYAK BLK XL
88991152	DOVE DECAL SM HANDLE - H LOGO	-	5143XXL	T-SHIRT KAYAK BLK XXL
88991191	V-FRAME STRUT 3/8-TDM ISLAND	-	5144LG	T-SHIRT KAYAK WHT LG
88991201	V-FRAME BASE 3/8-TDM ISLAND	-	5144MD	T-SHIRT KAYAK WHT MD
88991211	V-FRAME TURNBUCKLE 3/8-TDM ISL	-	5144SM	T-SHIRT KAYAK WHT SM
88991215	SET SCREW, TI MAST V BRACE	-	5144XL	T-SHIRT KAYAK WHT XL
88991221	CONNECTOR END, AKA BRACE	-	5144XXL	T-SHIRT KAYAK WHT XXL
88991235	DOWEL PIN 3/16 x 1-1/2"	-	5145LG	T-SHIRT KAYAK CYAN LG
88991271	SPACER BLOCK - MAST CUP -TDM I	-	5145MD	T-SHIRT KAYAK CYAN MD
88991281	STEERING CRANK, A/ITI (2011)	-	5145SM	T-SHIRT KAYAK CYAN SM
88991301	STEERING HANDLE-TDM ISLAND	-	5145XL	T-SHIRT KAYAK CYAN XL
88991303	AMA - TDM ISLAND PAPAYA	OS	5145XXL	T-SHIRT KAYAK CYAN XXL
88991304	AMA - TDM ISLAND HIBISCUS DK	OS	5146MD	T-SHIRT FISH BLK MD
88991305	AMA - TDM ISLAND DUNE	OS	5146SM	T-SHIRT FISH BLK SM
88991311	MAST CAP A/ITI	-	5146XL	T-SHIRT FISH BLK XL
88991314	AMA - TDM ISLAND HIBISCUS BRT	OS	5146XXL	T-SHIRT FISH BLK XXL
88991351	KNOB - STEERING HANDLE	-	5147LG	T-SHIRT FISH WHT LG
88991352	KNOB CAP	-	5147MD	T-SHIRT FISH WHT MD
88991355	KNOB ASSY, STEERING HANDLE	-	5147SM	T-SHIRT FISH WHT SM
88998514	SAIL-TDM ISLAND DUNE	OS	5147XL	T-SHIRT FISH WHT XL
88998515	SAIL-TDM ISLAND SMOKE	OS	5147XXL	T-SHIRT FISH WHT XXL
88998516	SAIL-TDM ISLAND BREEZE 3.8 OZ	OS	5148LG	T-SHIRT FISH CYAN LG
88998521	BATTEN TI #1 3/8" x 186" W/CAP	-	5148MD	T-SHIRT FISH CYAN MD
88998522	BATTEN TI #2 3/16" x 42.5" W/	-	5148SM	T-SHIRT FISH CYAN SM
88998523	BATTEN TI #3 3/16" x 39.5" W/	-	5148XL	T-SHIRT FISH CYAN XL
88998531	BATTEN CAP 1/4 DIA	-	5148XXL	T-SHIRT FISH CYAN XXL
88999519	BATTEN CAP 3/8 DIA (UAI)	-	5149LG	T-SHIRT JERVIS WHT LG
90610111	DELIRIN BALL 3/8 DIA - FURLERS	-	5149MD	T-SHIRT JERVIS WHT MD
91011001	BATTEN CAP 3/16 DIA	-	5149SM	T-SHIRT JERVIS WHT SM
91041011	BATTEN 3/16 FG ROD, 7' 8-1/2"	-	5149XL	T-SHIRT JERVIS WHT XL
91050010	HOOK WHT NYLON SEW-ON	-	5149XXL	T-SHIRT JERVIS WHT XXL
91050020	HOOK BLK NYLON SEW-ON	-	5153LG	T-SHIRT HYERES WHT LG
91051011	BATTEN 3/16 FG ROD, 9' 2"	-	5153MD	T-SHIRT HYERES WHT MD
99303001	ISLAND AMA REPL-PAPAYA	OS	5153SM	T-SHIRT HYERES WHT SM
99304001	ISLAND AMA REPL-OLD HIBISCUS	OS	5153XL	T-SHIRT HYERES WHT XL
99304101	ISLAND AMA REPL-NEW HIBISCUS	OS	5153XXL	T-SHIRT HYERES WHT XXL
99305001	ISLAND AMA REPL-DUNE	OS	5351B	HATCH COVER KIT 5" BLACK
99403002	ISLAND AMA KIT V2 - PAPAYA	OS	5351W	HATCH COVER KIT 5" WHITE
99404002	ISLAND AMA KIT V2 - HIBISCUS	OS	72000B	POUCH GUSSETED 6x12
99405002	ISLAND AMA KIT V2 - DUNE	OS	72005B	POUCH SUPER GUSSETED 8x15
99503002	ISLAND CONVERSION KIT V2 - PAP	OS	72210T	SEE BAG 8" X 14"
99504002	ISLAND CONVERSION KIT V2 - HIB	OS	72230T	SEE BAG 11" x 19"
99505002	ISLAND CONVERSION KIT V2 - DUN	OS	80000R	ROLLING DUFFLE/GEARBAG
99600001	INSTALL TOOLS - MAST HOLE SAW	-	80035A	ANCHOR w/BAG & LINE (3.5 LB)
99603001	ISLAND SAIL KIT - YELLOW-WHT	OS	B630808	RAIN ROLL TOP BAG 20x10 BLUE
99604001	ISLAND SAIL KIT - RED-WHT	OS	B630809	RAIN ROLL TOP BAG 20x10 YELLOW
99605001	ISLAND SAIL KIT - SILVER-WHT	OS	H071	SPRING-STANDUP
1553CR	CROAKIES "HOBBIE"	-	H082	BLOCK-SINGLE BULLET
1553L	LID LATCH MULTI-COLOR	-	H083	BLOCK-BULLET W/BECKET
1565BLK	SUNGLASSES HOBBIE ESCONDIDO	-	H092	BLOCK-BULLET CHEEK
1825WHT	TOYBOX	OS	H093	SPRING, MICRO CAM CLEAT MS-093
23015575-10	EXPLORER 3PC STRETCH 7.5 ADJ S	-	H166	BLOCK-BULLET SWIVEL
3188LG	GLOVES HOBBIE LARGE	-	H167	BLOCK-BULLET SWIVEL W/BECKET
3188MD	GLOVES HOBBIE MEDIUM	-	H2131	SHACKLE 4 MM BOW W/5/32" PIN
3188SM	GLOVES HOBBIE SMALL	-	H224	BLOCK-MICRO SINGLE
3188XL	GLOVES HOBBIE X LARGE	-	H225	BLOCK-MICRO W/BECKET
3850LG	HOBBIE SPRAY TOP LG	-	H233	BLOCK-MICRO CHEEK
3850MD	HOBBIE SPRAY TOP MD	-	H2655	BLOCK, 40mm CARBO FIDDLE
3850SM	HOBBIE SPRAY TOP SM	-	H281	EYESTRAP-MICRO SS
3850XL	HOBBIE SPRAY TOP XL	-	H284	KIT-MICRO WIRE FAIRLEAD
3857LG	SHIRT, MEN'S SPORT-T LS LG	-	H297	WEDGE KIT-MICRO CAM
3857MD	SHIRT, MEN'S SPORT-T LS MD	-	H350	29mm CARBO CHEEK
3857SM	SHIRT, MEN'S SPORT-T LS SM	-	H404	BLOCK-16MM AIR FXD SGL
3857XL	SHIRT, MEN'S SPORT-T LS XL	-	H405	BLOCK-16MM AIR FIXED SGL W/BKT
3858LG	SHIRT, MEN'S SPORT-T SS LG	-	H406	BLOCK-16MM AIR FIXED DOUBLE
3858SM	SHIRT, MEN'S SPORT-T SS SM	-	H407	BLOCK-16MM AIR FIXED DBL W/BKT
3858XL	SHIRT, MEN'S SPORT-T SS XL	-	H424B	FAIRLEAD MICRO CAM - BLK
3859LG	SHIRT,LADIES SPORT-T SS VN LG	-	H471	CAM CLEAT-MICRO CARBO

INDEX

Part	Description	OS		
HRG02010AL	HOBBIE LS SURF RASH WHT L	-	RF4850XL	GLOVES-FINGERLESS XL STICKY
HRG02010AM	HOBBIE LS SURF RASH WHT M	-	RF4850XS	GLOVES-FINGERLESS XS STICKY
HRG02010AS	HOBBIE LS SURF RASH WHT S	-	RF4851LG	GLOVES-3 FINGER LG STICKY
HRG02010AXL	HOBBIE LS SURF RASH WHT XL	-	RF4851MD	GLOVES-3 FINGER MD STICKY
HRG02010AXXL	HOBBIE LS SURF RASH WHT XXL	-	RF4851SM	GLOVES-3 FINGER SM STICKY
HRG020TNVL	HOBBIE LS SURF RASH NVY L	-	RF4851XL	GLOVES-3 FINGER XL STICKY
HRG020TNVM	HOBBIE LS SURF RASH NVY M	-	RF4851XS	GLOVES-3 FINGER XS STICKY
HRG020TNVS	HOBBIE LS SURF RASH NVY S	-	RH014WHT	LINE 1/4" STRAIT-CORE POLY
HRG020TNVXL	HOBBIE LS SURF RASH NVY XL	-	RH018WHT	LINE 1/8" NYLON BRAID WHITE
HRG020TNVXXL	HOBBIE LS SURF RASH NVY XXL	-	RH038WHT	LINE 3/8" STRAIT-CORE POLY
HRG03000CL	H SS SURF RASH GRY L	-	RH112WHT	LINE 1/12" NYLON BRAID WHITE
HRG03000CM	H SS SURF RASH GRY M	-	RH316WHT	LINE 3/16" STRAIT-CORE POLY
HRG03000CS	H SS SURF RASH GRY S	-	RH516WHT	LINE 5/16" STRAIT-CORE POLY
HRG03000CXL	H SS SURF RASH GRY XL	-	RM014BLK	LINE 1/4" SPUN DACRON - BLACK
HRG03000CXXL	H SS SURF RASH GRY XXL	-	RM014BLU	LINE 1/4" SPUN DACRON - BLUE
HRG03010AL	H SS SURF RASH WHT L	-	RM014RED	LINE 1/4" SPUN DACRON - RED
HRG03010AM	H SS SURF RASH WHT M	-	RM014WHT	LINE 1/4" SPUN DBL BRD - WHITE
HRG03010AS	H SS SURF RASH WHT S	-	RM038BLK	LINE 3/8" SPUN DACRON - BLACK
HRG03010AXL	H SS SURF RASH WHT XL	-	RM038BLU	LINE 3/8" SPUN DACRON - BLUE
HRG03010AXXL	H SS SURF RASH WHT XXL	-	RM038RED	LINE 3/8" SPUN DACRON - RED
HRG04000AL	H LS SURF RASH BLK L	-	RM038WHT	LINE 3/8" SPUN DBL BRD - WHITE
HRG04000AM	H LS SURF RASH BLK M	-	RM516BLK	LINE 5/16" SPUN DACRON - BLK
HRG04000AS	H LS SURF RASH BLK S	-	RM516BLU	LINE 5/16" SPUN DACRON - BLUE
HRG04000AXL	H LS SURF RASH BLK XL	-	RM516RED	LINE 5/16" SPUN DACRON - RED
HRG04000AXXL	H LS SURF RASH BLK XXL	-	RM516WHT	LINE 5/16" SPUN DBL BRD-WHITE
HRG04000CL	H LS SURF RASH GRY L	-	RM716BLK	LINE 7/16" SPUN DACRON - BLACK
HRG04000CM	H LS SURF RASH GRY M	-	RM716BLU	LINE 7/16" SPUN DACRON - BLUE
HRG04000CS	H LS SURF RASH GRY S	-	RM716RED	LINE 7/16" SPUN DACRON - RED
HRG04000CXL	H LS SURF RASH GRY XL	-	RM716WHT	LINE 7/16" SPUN DACRON - WHITE
HRG04000CXXL	H LS SURF RASH GRY XXL	-	RS014BLK	SHOCKCORD 1/4" BLACK
HRG05010AL	HOBBIE SS SURF RASH WHT L	-	RS018BLK	SHOCKCORD 1/8" BLACK
HRG05010AM	HOBBIE SS SURF RASH WHT M	-	RS038BLK	SHOCKCORD 3/8" BLACK
HRG05010AS	HOBBIE SS SURF RASH WHT S	-	RS316BLK	SHOCKCORD 3/16" BLACK
HRG05010AXL	HOBBIE SS SURF RASH WHT XL	-	RS516BLK	SHOCKCORD 5/16" BLACK
HRG05010AXXL	HOBBIE SS SURF RASH WHT XXL	-	RS716BLK	SHOCKCORD 7/16" BLACK
HRG050TNVL	HOBBIE SS SURF RASH NVY L	-	S6142MD	PFD WEDGE-E MD
HRG050TNVM	HOBBIE SS SURF RASH NVY M	-	S6142SM	PFD WEDGE-E SM
HRG050TNVS	HOBBIE SS SURF RASH NVY S	-	S6142XL	PFD WEDGE-E XL
HRG050TNVXL	HOBBIE SS SURF RASH NVY XL	-	S6142XXL	PFD WEDGE-E XXL
HRG050TNVXXL	HOBBIE SS SURF RASH NVY XXL	-	S6143LXL	PFD HI-BACK ZIP MANGO LXL
HTS020GRN2L	PHOTO FINISH GRN2 L	-	S6143SMD	PFD HI-BACK ZIP MANGO SMD
HTS020GRN2M	PHOTO FINISH GRN2 M	-	S6143XXL	PFD HI-BACK ZIP MANGO XXL
HTS020GRN2S	PHOTO FINISH GRN2 S	-	S6145LXL	PFD HIBACK MANGO (ULC) LXL
HTS020GRN2XL	PHOTO FINISH GRN2 XL	-	S6145SMD	PFD HIBACK MANGO (ULC) SMD
HTS020GRN2XXL	PHOTO FINISH GRN2 XXL	-	S6146MLG	PFD HI-BACK P-BLUE (W) MLG
HTS020OFWL	PHOTO FINISH OFW L	-	S6146PS	PFD HI-BACK P-BLUE (W) PS
HTS020OFWM	PHOTO FINISH OFW M	-	S6146XSS	PFD HI-BACK P-BLUE (W) XSS
HTS020OFWS	PHOTO FINISH OFW S	-	S6147MLG	PFD HI-BACK MANGO (W) MLG
HTS020OFWXL	PHOTO FINISH OFW XL	-	S6147PS	PFD HI-BACK MANGO (W) PS
HTS020OFWXXL	PHOTO FINISH OFW XXL	-	S6147XSS	PFD HI-BACK MANGO (W) XSS
HTS020TNVL	PHOTO FINISH TNV L	-	S6148LXL	PFD FISHERMAN MANGO LXL
HTS020TNVM	PHOTO FINISH TNV M	-	S6148SMD	PFD FISHERMAN MANGO SMD
HTS020TNVS	PHOTO FINISH TNV S	-	S6148XXL	PFD FISHERMAN MANGO XXL
HTS020TNVXL	PHOTO FINISH TNV XL	-	S6149LXL	PFD FISHERMAN CACTUS LXL
HTS020TNVXXL	PHOTO FINISH TNV XXL	-	S6149SMD	PFD FISHERMAN CACTUS SMD
HTS0550HABL	SUNSET FISH SHRT HAB L	-	S6149XXL	PFD FISHERMAN CACTUS XXL
HTS0550HABM	SUNSET FISH SHRT HAB M	-	S6770CMG	PFD CHILD MANGO 30-50#
HTS0550HABS	SUNSET FISH SHRT HAB S	-	S6770IMG	PFD INFANT MANGO <30#
HTS0550HABXL	SUNSET FISH SHRT HAB XL	-	S6770YMG	PFD YOUTH MANGO 50-90#
HTS0550HABXXL	SUNSET FISH SHRT HAB XXL	-	S6779MG	PFD INFLATABLE MANGO
HTS0550SNDL	SUNSET FISH SHRT SND L	-	S6779R	PFD INFLATABLE REARM KIT
HTS0550SNDM	SUNSET FISH SHRT SND M	-	S6779RG	PFD INFLATABLE RED/GRAY
HTS0550SND S	SUNSET FISH SHRT SND S	-	S6779TG	PFD INFLATABLE TAN/GRAY
HTS0550SNDXL	SUNSET FISH SHRT SND XL	-	S6780RG	PFD BELT PACK INFLATABLE RED/G
HTS0550SNDXXL	SUNSET FISH SHRT SND XXL	-	S6800LXL	PFD MIRAGE GRAY - LARGE / XL
HTS058010AL	OWNERS SHRT 10A L	-	S6800MLG	PFD MIRAGE GRAY - MED / LARGE
HTS058010AM	OWNERS SHRT 10A M	-	S6800SMD	PFD MIRAGE GRAY - SMALL / MED
HTS058010AS	OWNERS SHRT 10A S	-	SP150041	SHACKLE 5/32 X 3/8 X 5/8
HTS058010AXL	OWNERS SHRT 10A XL	-	SP150051	SHACKLE 3/16x1/2x11/16
HTS058010AXXL	OWNERS SHRT 10A XXL	-	SP150052	SHACKLE 3/16 x 5/8 x 5/16
HTS0580NVYL	OWNERS SHRT NVY L	-	SP150053	SHACKLE 3/16 X 5/8 X 1-7/16
HTS0580NVYM	OWNERS SHRT NVY M	-	SP150061	SHACKLE 1/4x9/16x15/16
HTS0580NVYS	OWNERS SHRT NVY S	-	SP170005	SHACKLE TWISTED SS 3/16
HTS0580NVYXL	OWNERS SHRT NVY XL	-	SP170006	SHACKLE TWISTED SS 1/4
HTS0580NVYXXL	OWNERS SHRT NVY XXL	-	SP180005	SHACKLE W/ SAFETY KEY PIN 3/16"
HTS059010AL	COAST TO SHRT 10A L	-	SP180006	SHACKLE W/ SAFETY KEY PIN 1/4"
HTS059010AM	COAST TO SHRT 10A M	-	SP185205	SHACKLE W/ SAFETY KEY PIN 3/16"
HTS059010AS	COAST TO SHRT 10A S	-	V1093	SCREW-IN DECKPLATE 5" CRVD WH
HTS059010AXL	COAST TO SHRT 10A XL	-	V1100	SCREW-IN DECKPLATE 5" CRVD BLA
HTS059010AXXL	COAST TO SHRT 10A XXL	-	V1130	SCREW-IN DECKPLATE 4" CRVD WH
HTS0590HTGL	COAST TO SHRT HTG L	-	V1131	SCREW-IN DECKPLATE 4" CRVD BL
HTS0590HTGM	COAST TO SHRT HTG M	-	V1145	SCREW-IN DECKPLATE 6" WHITE W
HTS0590HTGS	COAST TO SHRT HTG S	-	V1146	SCREW-IN DECKPLATE 6" BLACK W/
HTS0590HTGXL	COAST TO SHRT HTG XL	-		
HTS0590HTGXXL	COAST TO SHRT HTG XXL	-		
HTS070NVYL	DIAMOND NVY L	-		
HTS070NVYM	DIAMOND NVY M	-		
HTS070NVYS	DIAMOND NVY S	-		
HTS070NVYXL	DIAMOND NVY XL	-		
HTS070NVYXXL	DIAMOND NVY XXL	-		
HTS070WHTL	DIAMOND WHT L	-		
HTS070WHTM	DIAMOND WHT M	-		
HTS070WHTS	DIAMOND WHT S	-		
HTS070WHTXL	DIAMOND WHT XL	-		
HTS070WHTXXL	DIAMOND WHT XXL	-		
MK0053	PROMOTIONAL - SAFETY WHISTLES	-		
RF4050	CLEAR START RACE TIMER	-		
RF4052A	CLEAR START SAILING WATCH	-		
RF4850LG	GLOVES-FINGERLESS LG STICKY	-		
RF4850MD	GLOVES-FINGERLESS MD STICKY	-		
RF4850SM	GLOVES-FINGERLESS SM STICKY	-		





YOU BELONG ON A HOBIE



hobiecat.com





HOBIE CAT COMPANY

Holding Company
Oceanside, CA, U.S.A.
1-800-HOBIE-49
hobiecat.com

HOBIE CAT AUSTRALASIA

Subsidiary
Huskisson, NSW, Australia
1-800-4-HOBIE
hobiecat.com.au

HOBIE CAT EUROPE

Subsidiary
Toulon, France
+33 (0) 494 08 78 78
hobie-cat.net

HOBIE KAYAK EUROPE

Independent Distributor
Stellendam, The Netherlands
+31 (0) 187 499 440
hobie-kayak.com

HOBIE CAT BRASIL

Independent Distributor
Bahia, Brasil
+55 (73) 9982 2424
hobiecat.com.br

HOBIE: Master of Water, Wind and Waves

The man, Hobie, known by just one name worldwide, has an epic life story. This 12 x 9 hardcover book shows how it all came to be, and more, in 17 chapters with 300 pages, 120,000 words of text and 585 photographs and illustrations that document Hobie's entire life and career.

Own a part of the legend!

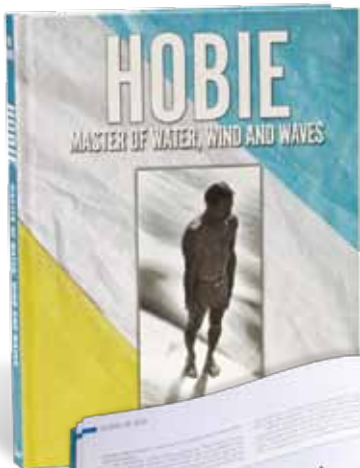

87369116 BOOK, HOBIE-MASTER OF WATER, WIND, AND WAVES



KAYAKING+FISHING PARTS AND ACCESSORIES

INTERNATIONAL 87367024